

## Notice of Violation

### City of Osceola

Office of Code Enforcement

303 West Hale Avenue P.O. Box 443

Osceola, AR 72370

Phone (870) 563-5245

Fax (870) 563-5195 or (870) 497-2228



A Community United for Progress

02/04/2022

TIPTON, KATHERINE

904 RUBY OSCEOLA AR 72370

Subject Property: 906 RUBY AR, , AR

Dear Property Owner:

YOU ARE HEREBY NOTIFIED TO DO THE FOLLOWING TO CORRECT THE VIOLATION(S) INDICATED BELOW:

**5.12.03 Weeds and Grass, Etc., Removal** - Weeds and grass, removal of rubbish, open storage, stagnant water. It shall be unlawful for any person owning and/or occupying any lot or real property within the City of Osceola, Arkansas, to allow weeds to grow thereon to a greater height of more than twelve (12) inches or to become unsightly or unsanitary, or to allow grass, garbage, rubbish, rotting or dead limbs or trees to become unsafe, unsightly and unsanitary or allow any icebox, refrigerator, stove, tires, building material, paper, building rubbish to be openly stored, or allow similar unsafe, unsightly and unsanitary. Ord. No. 2009-867.

**Action to be taken:**

Rubbish and debris in backyard must be addressed within 30 days.

FAILURE TO CORRECT VIOLATION(S) WILL RESULT IN ISSUANCE OF A COURT SUMMONS TO APPEAR IN DISTRICT COURT. THE MAXIMUM FINE PER COURT SUMMONS IS \$100.00 EACH DAY IS A SEPARATE OFFENSE. THE CLEANUP BEING PERFORMED BY CITY OFFICIALS ON THE PROPERTY WILL RESULT IN PAYMENT AT THE OWNER(S) EXPENSE OF \$100.00 OR TEN PERCENT (10%) OF THE TOTAL COSTS INCURRED BY THE CITY TO REMEDY THE VIOLATION, WHICHEVER IS GREATER, AND AN ADDITION OF THE ACTUAL COST OF THE WORK INVOLVED IN CORRECTING THE CONDITIONS. A LIEN MAY BE FILED AGAINST THE PROPERTY AND AGAINST YOU AS THE OWNER FOR UNPAID FEES.

Thank You,

Office of Code Enforcement





906 Ruby Ave



## Notice of Violation

### City of Osceola

Office of Code Enforcement

303 West Hale Avenue P.O. Box 443

Osceola, AR 72370

Phone (870) 563-5245

Fax (870) 563-5195 or (870) 497-2228



02/07/2022

LALLAMANT, ELSIE

416 1/2 W BARD OSCEOLA AR 72370

Subject Property: 416 W BARD OSCEOLA AR, , AR

Dear Property Owner:

YOU ARE HEREBY NOTIFIED TO DO THE FOLLOWING TO CORRECT THE VIOLATION(S) INDICATED BELOW:

**5.04.01 Property Maintenance** - It shall be unlawful for the owner, owners or occupant of any lot or other real property within the City of Osceola, Arkansas to maintain or allow any dilapidated or unsightly building or structure on such lot or real property. Ord. No. 1991-650.

**5.12.03 Weeds and Grass, Etc., Removal** - Weeds and grass, removal of rubbish, open storage, stagnant water. It shall be unlawful for any person owning and/or occupying any lot or real property within the City of Osceola, Arkansas, to allow weeds to grow thereon to a greater height of more than twelve (12) inches or to become unsightly or unsanitary, or to allow grass, garbage, rubbish, rotting or dead limbs or trees to become unsafe, unsightly and unsanitary or allow any icebox, refrigerator, stove, tires, building material, paper, building rubbish to be openly stored, or allow similar unsafe, unsightly and unsanitary. Ord. No. 2009-867.

**Action to be taken:**

Violations must be corrected within 30 days.

FAILURE TO CORRECT VIOLATION(S) WILL RESULT IN ISSUANCE OF A COURT SUMMONS TO APPEAR IN DISTRICT COURT. THE MAXIMUM FINE PER COURT SUMMONS IS \$100.00 EACH DAY IS A SEPARATE OFFENSE. THE CLEANUP BEING PERFORMED BY CITY OFFICIALS ON THE PROPERTY WILL RESULT IN PAYMENT AT THE OWNER(S) EXPENSE OF \$100.00 OR TEN PERCENT (10%) OF THE TOTAL COSTS INCURRED BY THE CITY TO REMEDY THE VIOLATION, WHICHEVER IS GREATER, AND AN ADDITION OF THE ACTUAL COST OF THE WORK INVOLVED IN CORRECTING THE CONDITIONS. A LIEN MAY BE FILED AGAINST THE PROPERTY AND AGAINST YOU AS THE OWNER FOR UNPAID FEES.

Thank You,

Office of Code Enforcement





416 W Bond Ave



## Notice of Violation

### City of Osceola

Office of Code Enforcement

303 West Hale Avenue P.O. Box 443

Osceola, AR 72370

Phone (870) 563-5245

Fax (870) 563-5195 or (870) 497-2228



A Community United for Progress

02/07/2022

GILES, LEROY & GERTHA  
406 W LEE OSCEOLA AR 72370

Subject Property: 418 W BARD AR, , AR

Dear Property Owner:

YOU ARE HEREBY NOTIFIED TO DO THE FOLLOWING TO CORRECT THE VIOLATION(S) INDICATED BELOW:

**5.08.01 Inoperable Vehicles** - It shall be unlawful for the owner, owners, or occupant of any lot or other real property within the City of Osceola, Arkansas to utilize the premises for Commercial and/or open storage of any inoperable motor vehicle. An inoperable motor vehicle for the purpose of this Ordinance, is defined as one that is in a state of disrepair and incapable of being moved under it's own power or one that does not have current, valid license plates. Ord. No. 1993-679.

**5.12.03 Weeds and Grass, Etc., Removal** - Weeds and grass, removal of rubbish, open storage, stagnant water. It shall be unlawful for any person owning and/or occupying any lot or real property within the City of Osceola, Arkansas, to allow weeds to grow thereon to a greater height of more than twelve (12) inches or to become unsightly or unsanitary, or to allow grass, garbage, rubbish, rotting or dead limbs or trees to become unsafe, unsightly and unsanitary or allow any icebox, refrigerator, stove, tires, building material, paper, building rubbish to be openly stored, or allow similar unsafe, unsightly and unsanitary. Ord. No. 2009-867.

**Action to be taken:**

Violations must be corrected within 7 days.

FAILURE TO CORRECT VIOLATION(S) WILL RESULT IN ISSUANCE OF A COURT SUMMONS TO APPEAR IN DISTRICT COURT. THE MAXIMUM FINE PER COURT SUMMONS IS \$100.00 EACH DAY IS A SEPARATE OFFENSE. THE CLEANUP BEING PERFORMED BY CITY OFFICIALS ON THE PROPERTY WILL RESULT IN PAYMENT AT THE OWNER(S) EXPENSE OF \$100.00 OR TEN PERCENT (10%) OF THE TOTAL COSTS INCURRED BY THE CITY TO REMEDY THE VIOLATION, WHICHEVER IS GREATER, AND AN ADDITION OF THE ACTUAL COST OF THE WORK INVOLVED IN CORRECTING THE CONDITIONS. A LIEN MAY BE FILED AGAINST THE PROPERTY AND AGAINST YOU AS THE OWNER FOR UNPAID FEES.

Thank You,

Office of Code Enforcement





418 W Bond Ave



## Notice of Violation

### City of Osceola

Office of Code Enforcement

303 West Hale Avenue P.O. Box 443

Osceola, AR 72370

Phone (870) 563-5245

Fax (870) 563-5195 or (870) 497-2228



02/07/2022

HARSHMAN RENTALS LLC  
202 W JOHNSON OSCEOLA AR 72370

*Rodney Holmes*  
Subject Property: 512 W FORD AR, , AR

Dear Property Owner:

YOU ARE HEREBY NOTIFIED TO DO THE FOLLOWING TO CORRECT THE VIOLATION(S) INDICATED BELOW:

**5.12.03 Weeds and Grass, Etc., Removal** - Weeds and grass, removal of rubbish, open storage, stagnant water. It shall be unlawful for any person owning and/or occupying any lot or real property within the City of Osceola, Arkansas, to allow weeds to grow thereon to a greater height of more than twelve (12) inches or to become unsightly or unsanitary, or to allow grass, garbage, rubbish, rotting or dead limbs or trees to become unsafe, unsightly and unsanitary or allow any icebox, refrigerator, stove, tires, building material, paper, building rubbish to be openly stored, or allow similar unsafe, unsightly and unsanitary. Ord. No. 2009-867.

**Action to be taken:**

Violations must be corrected within 7 days.

FAILURE TO CORRECT VIOLATION(S) WILL RESULT IN ISSUANCE OF A COURT SUMMONS TO APPEAR IN DISTRICT COURT. THE MAXIMUM FINE PER COURT SUMMONS IS \$100.00 EACH DAY IS A SEPARATE OFFENSE. THE CLEANUP BEING PERFORMED BY CITY OFFICIALS ON THE PROPERTY WILL RESULT IN PAYMENT AT THE OWNER(S) EXPENSE OF \$100.00 OR TEN PERCENT (10%) OF THE TOTAL COSTS INCURRED BY THE CITY TO REMEDY THE VIOLATION, WHICHEVER IS GREATER, AND AN ADDITION OF THE ACTUAL COST OF THE WORK INVOLVED IN CORRECTING THE CONDITIONS. A LIEN MAY BE FILED AGAINST THE PROPERTY AND AGAINST YOU AS THE OWNER FOR UNPAID FEES.

Thank You,

Office of Code Enforcement



512 W Ford Ave  
Rodney Holmes



## Notice of Violation

### City of Osceola

Office of Code Enforcement

303 West Hale Avenue P.O. Box 443

Osceola, AR 72370

Phone (870) 563-5245

Fax (870) 563-5195 or (870) 497-2228



A Community United for Progress

02/07/2022

WILLIAMS, KEVIN F  
425 W QUINN OSCEOLA AR 72370

Subject Property: 505 W LEE OSCEOLA AR, , AR

Dear Property Owner:

YOU ARE HEREBY NOTIFIED TO DO THE FOLLOWING TO CORRECT THE VIOLATION(S) INDICATED BELOW:

**5.12.03 Weeds and Grass, Etc., Removal** - Weeds and grass, removal of rubbish, open storage, stagnant water. It shall be unlawful for any person owning and/or occupying any lot or real property within the City of Osceola, Arkansas, to allow weeds to grow thereon to a greater height of more than twelve (12) inches or to become unsightly or unsanitary, or to allow grass, garbage, rubbish, rotting or dead limbs or trees to become unsafe, unsightly and unsanitary or allow any icebox, refrigerator, stove, tires, building material, paper, building rubbish to be openly stored, or allow similar unsafe, unsightly and unsanitary. Ord. No. 2009-867.

**Action to be taken:**

Violation must be corrected within 30 days. Rubbish and litter must be removed from porch, driveway, yard and carport within 30days.

FAILURE TO CORRECT VIOLATION(S) WILL RESULT IN ISSUANCE OF A COURT SUMMONS TO APPEAR IN DISTRICT COURT. THE MAXIMUM FINE PER COURT SUMMONS IS \$100.00 EACH DAY IS A SEPARATE OFFENSE. THE CLEANUP BEING PERFORMED BY CITY OFFICIALS ON THE PROPERTY WILL RESULT IN PAYMENT AT THE OWNER(S) EXPENSE OF \$100.00 OR TEN PERCENT (10%) OF THE TOTAL COSTS INCURRED BY THE CITY TO REMEDY THE VIOLATION, WHICHEVER IS GREATER, AND AN ADDITION OF THE ACTUAL COST OF THE WORK INVOLVED IN CORRECTING THE CONDITIONS. A LIEN MAY BE FILED AGAINST THE PROPERTY AND AGAINST YOU AS THE OWNER FOR UNPAID FEES.

Thank You,

Office of Code Enforcement



505 W Lee



## Notice of Violation

### City of Osceola

Office of Code Enforcement

303 West Hale Avenue P.O. Box 443

Osceola, AR 72370

Phone (870) 563-5245

Fax (870) 563-5195 or (870) 497-2228



02/07/2022

WILLIAMS, KEVIN F  
425 W QUINN OSCEOLA AR 72370

*Scott Russell*

Subject Property: 505 W LEE OSCEOLA AR, , AR

Dear Property Owner:

YOU ARE HEREBY NOTIFIED TO DO THE FOLLOWING TO CORRECT THE VIOLATION(S) INDICATED BELOW:

**5.12.03 Weeds and Grass, Etc., Removal** - Weeds and grass, removal of rubbish, open storage, stagnant water. It shall be unlawful for any person owning and/or occupying any lot or real property within the City of Osceola, Arkansas, to allow weeds to grow thereon to a greater height of more than twelve (12) inches or to become unsightly or unsanitary, or to allow grass, garbage, rubbish, rotting or dead limbs or trees to become unsafe, unsightly and unsanitary or allow any icebox, refrigerator, stove, tires, building material, paper, building rubbish to be openly stored, or allow similar unsafe, unsightly and unsanitary. Ord. No. 2009-867.

**Action to be taken:**

Violation must be corrected within 30 days. Rubbish and litter must be removed from porch, driveway, yard and carport within 30days.

FAILURE TO CORRECT VIOLATION(S) WILL RESULT IN ISSUANCE OF A COURT SUMMONS TO APPEAR IN DISTRICT COURT. THE MAXIMUM FINE PER COURT SUMMONS IS \$100.00 EACH DAY IS A SEPARATE OFFENSE. THE CLEANUP BEING PERFORMED BY CITY OFFICIALS ON THE PROPERTY WILL RESULT IN PAYMENT AT THE OWNER(S) EXPENSE OF \$100.00 OR TEN PERCENT (10%) OF THE TOTAL COSTS INCURRED BY THE CITY TO REMEDY THE VIOLATION, WHICHEVER IS GREATER, AND AN ADDITION OF THE ACTUAL COST OF THE WORK INVOLVED IN CORRECTING THE CONDITIONS. A LIEN MAY BE FILED AGAINST THE PROPERTY AND AGAINST YOU AS THE OWNER FOR UNPAID FEES.

Thank You,

Office of Code Enforcement





505 W Lee



## Notice of Violation

### City of Osceola

Office of Code Enforcement

303 West Hale Avenue P.O. Box 443

Osceola, AR 72370

Phone (870) 563-5245

Fax (870) 563-5195 or (870) 497-2228



02/07/2022

SMITH, AMANDA J

511 W LEE OSCEOLA AR 72370

*Shanna Pope*

Subject Property: 511 W LEE AR, , AR

Dear Property Owner:

YOU ARE HEREBY NOTIFIED TO DO THE FOLLOWING TO CORRECT THE VIOLATION(S) INDICATED BELOW:

**5.08.01 Inoperable Vehicles** - It shall be unlawful for the owner, owners, or occupant of any lot or other real property within the City of Osceola, Arkansas to utilize the premises for Commercial and/or open storage of any inoperable motor vehicle. An inoperable motor vehicle for the purpose of this Ordinance, is defined as one that is in a state of disrepair and incapable of being moved under it's own power or one that does not have current, valid license plates. Ord. No. 1993-679.

**5.12.03 Weeds and Grass, Etc., Removal** - Weeds and grass, removal of rubbish, open storage, stagnant water. It shall be unlawful for any person owning and/or occupying any lot or real property within the City of Osceola, Arkansas, to allow weeds to grow thereon to a greater height of more than twelve (12) inches or to become unsightly or unsanitary, or to allow grass, garbage, rubbish, rotting or dead limbs or trees to become unsafe, unsightly and unsanitary or allow any icebox, refrigerator, stove, tires, building material, paper, building rubbish to be openly stored, or allow similar unsafe, unsightly and unsanitary. Ord. No. 2009-867.

**Action to be taken:**

Inoperable cars and rubbish in yard must be removed from property within 7 days.

FAILURE TO CORRECT VIOLATION(S) WILL RESULT IN ISSUANCE OF A COURT SUMMONS TO APPEAR IN DISTRICT COURT. THE MAXIMUM FINE PER COURT SUMMONS IS \$100.00 EACH DAY IS A SEPARATE OFFENSE. THE CLEANUP BEING PERFORMED BY CITY OFFICIALS ON THE PROPERTY WILL RESULT IN PAYMENT AT THE OWNER(S) EXPENSE OF \$100.00 OR TEN PERCENT (10%) OF THE TOTAL COSTS INCURRED BY THE CITY TO REMEDY THE VIOLATION, WHICHEVER IS GREATER, AND AN ADDITION OF THE ACTUAL COST OF THE WORK INVOLVED IN CORRECTING THE CONDITIONS. A LIEN MAY BE FILED AGAINST THE PROPERTY AND AGAINST YOU AS THE OWNER FOR UNPAID FEES.

Thank You,

Office of Code Enforcement





511 W Lee Ave





511 W Lee Ave



## Notice of Violation

### City of Osceola

Office of Code Enforcement

303 West Hale Avenue P.O. Box 443

Osceola, AR 72370

Phone (870) 563-5245

Fax (870) 563-5195 or (870) 497-2228



02/04/2022

OAKES, STEVEN L & DANYEL D  
201 S MARJORIE OSCEOLA AR 72370

Subject Property: 201 S MARJORIE AR, , AR

Dear Property Owner:

YOU ARE HEREBY NOTIFIED TO DO THE FOLLOWING TO CORRECT THE VIOLATION(S) INDICATED BELOW:

**5.08.01 Inoperable Vehicles** - It shall be unlawful for the owner, owners, or occupant of any lot or other real property within the City of Osceola, Arkansas to utilize the premises for Commercial and/or open storage of any inoperable motor vehicle. An inoperable motor vehicle for the purpose of this Ordinance, is defined as one that is in a state of disrepair and incapable of being moved under it's own power or one that does not have current, valid license plates. Ord. No. 1993-679.

**Action to be taken:**

Camper must be removed within 7 days.

FAILURE TO CORRECT VIOLATION(S) WILL RESULT IN ISSUANCE OF A COURT SUMMONS TO APPEAR IN DISTRICT COURT. THE MAXIMUM FINE PER COURT SUMMONS IS \$100.00 EACH DAY IS A SEPARATE OFFENSE. THE CLEANUP BEING PERFORMED BY CITY OFFICIALS ON THE PROPERTY WILL RESULT IN PAYMENT AT THE OWNER(S) EXPENSE OF \$100.00 OR TEN PERCENT (10%) OF THE TOTAL COSTS INCURRED BY THE CITY TO REMEDY THE VIOLATION, WHICHEVER IS GREATER, AND AN ADDITION OF THE ACTUAL COST OF THE WORK INVOLVED IN CORRECTING THE CONDITIONS. A LIEN MAY BE FILED AGAINST THE PROPERTY AND AGAINST YOU AS THE OWNER FOR UNPAID FEES.

Thank You,

Office of Code Enforcement





201 S Marjorie St



## **TITLE 9**

### **STREETS AND SIDEWALKS**

#### **Chapters:**

9.04 Streets, Alleys, and Sidewalks

#### **Chapter 9.04**

#### **Streets, Alleys, and Sidewalks**

#### **Sections:**

9.04.01 Parking Regulations

##### **9.04.01 Parking Regulations**

1. It shall be unlawful for any person to park a motor vehicle on Hale Avenue between Ash and Maple Streets for the duration of more than two (2) hours.
2. It shall be unlawful for any person to park a motor vehicle on Pecan Street, Railroad Street, Poplar Street and Walnut Street in an area one block north and south of Hale Avenue for the duration of more than two (2) hours.
3. The foregoing limitations on parking set forth in Sec. 1 and 2 shall apply during all days of the week except Sunday and only between the hours of 8:00 a.m. and 6:00 p.m.
4. It shall be unlawful for any person to park a motor vehicle on Hale Avenue between Ash and Maple Streets in any manner other than parallel to the curb along said streets and only within designated areas for parking.
5. Any person violating the provisions of this Ordinance shall be deemed guilty of a misdemeanor and upon conviction shall be fined in any sum of not less than one dollar (\$1.00) nor more than ten dollars (\$10.00). Ord. No. 416

##### **9.04.02 Regulating the Parking of Motor Homes, Recreational Vehicles, Campers, Boats, Trailers, Buses, Construction Equip, and Off-Road Vehicles on City Streets**

1. It shall be unlawful for the owner, owners, or any person having charge and or control of the above said vehicles, equipment and items, to park or store them on a city street, public right-of-way or alleyway except under the following



circumstances:

- A. The parking of the above said vehicles, equipment and items shall be of a temporary nature not to exceed three (3) hours in duration.
  - B. Temporary parking of the above said vehicles, equipment and items shall not be done in a manner as to unnecessarily impede the flow of traffic, block driveways or fire hydrants and shall not be closer than sixty (60) feet to a stop sign. Ord. No. 2008-847.
2. Exceptions
    - A. Parking of vehicles, equipment and items being used in the construction or repair of streets and utilities may exceed three (3) hours in duration when it is necessary to complete the construction or repair of streets or utilities.
    - B. Parking of vehicles, equipment and items on city streets, right-of-ways and alleyways that are being used in the course of medical, fire department and police department emergencies, procedures & actions may exceed three (3) hours in duration when it is necessary to complete the procedures and actions required.
    - C. Parking of service vehicles including, but not limited to, postal vehicles, meter reader vehicles, moving vans, delivery trucks and other types of service vehicles may exceed three (3) hours when it is necessary and essential for the providing of that particular service. Ord. No. 2008-847.
  3. A person being found in violation of this ordinance shall be fined not less than twenty-five (\$25.00) dollars and not more than one hundred (\$100) dollars; and each day such violation occurs or shall continue shall be considered a separate offence. Ord. No. 2008-847.

#### **9.04.03 Tractor Trailers**

1. From and after this date it shall be unlawful for any person, either the owner or operator, to park tractors and trailers, "18 wheelers", or either tractors or trailers, on the streets of Osceola in residential areas for more than 20 minutes during the daylight hours or more than 5 minutes in the nighttime.
2. From and after this date it shall be unlawful for any person, owner or operator, to operate any self-contained refrigeration unit on tractors, trailers or on tractors and trailers parked on the street in any residential area of the City of Osceola.
3. Any person violating the provisions of this ordinance shall be guilty of a misdemeanor and upon conviction shall be fined any sum of not less than \$25. 00 nor more than \$100.00 and each day the violation occurs shall be considered a separate offense. Ord. No. 1981-546.

#### **9.04.04 New Construction of Sidewalks**

1. That any new residential or commercial structures constructed in the City of



## Notice of Violation

### City of Osceola

Office of Code Enforcement

303 West Hale Avenue P.O. Box 443

Osceola, AR 72370

Phone (870) 563-5245

Fax (870) 563-5195 or (870) 497-2228



A Community United for Progress

02/04/2022

**WILDY, DON BRAXTON**

**110 BRICKEY OSCEOLA AR 72370**

Subject Property: 110 S BRICKEY OSCEOLA AR, , AR

Dear Property Owner:

YOU ARE HEREBY NOTIFIED TO DO THE FOLLOWING TO CORRECT THE VIOLATION(S) INDICATED BELOW:

**5.08.01 Inoperable Vehicles** - It shall be unlawful for the owner, owners, or occupant of any lot or other real property within the City of Osceola, Arkansas to utilize the premises for Commercial and/or open storage of any inoperable motor vehicle. An inoperable motor vehicle for the purpose of this Ordinance, is defined as one that is in a state of disrepair and incapable of being moved under it's own power or one that does not have current, valid license plates. Ord. No. 1993-679.

**Action to be taken:**

**Inoperable cars must be removed from property within 7 days.**

FAILURE TO CORRECT VIOLATION(S) WILL RESULT IN ISSUANCE OF A COURT SUMMONS TO APPEAR IN DISTRICT COURT. THE MAXIMUM FINE PER COURT SUMMONS IS \$100.00 EACH DAY IS A SEPARATE OFFENSE. THE CLEANUP BEING PERFORMED BY CITY OFFICIALS ON THE PROPERTY WILL RESULT IN PAYMENT AT THE OWNER(S) EXPENSE OF \$100.00 OR TEN PERCENT (10%) OF THE TOTAL COSTS INCURRED BY THE CITY TO REMEDY THE VIOLATION, WHICHEVER IS GREATER, AND AN ADDITION OF THE ACTUAL COST OF THE WORK INVOLVED IN CORRECTING THE CONDITIONS. A LIEN MAY BE FILED AGAINST THE PROPERTY AND AGAINST YOU AS THE OWNER FOR UNPAID FEES.

Thank You,

Office of Code Enforcement





110 S Bricky St



## Notice of Violation

### City of Osceola

Office of Code Enforcement

303 West Hale Avenue P.O. Box 443

Osceola, AR 72370

Phone (870) 563-5245

Fax (870) 563-5195 or (870) 497-2228



A Community United for Progress

02/04/2022

NACHLINGER, BOBBY J & THROYS  
537 ROCKY SPRINGS RD BEACHBLUFF TN 38313

*Jerry Davis*  
Subject Property: 907 RUBY AR, , AR

Dear Property Owner:

YOU ARE HEREBY NOTIFIED TO DO THE FOLLOWING TO CORRECT THE VIOLATION(S) INDICATED BELOW:

**5.12.03 Weeds and Grass, Etc., Removal** - Weeds and grass, removal of rubbish, open storage, stagnant water. It shall be unlawful for any person owning and/or occupying any lot or real property within the City of Osceola, Arkansas, to allow weeds to grow thereon to a greater height of more than twelve (12) inches or to become unsightly or unsanitary, or to allow grass, garbage, rubbish, rotting or dead limbs or trees to become unsafe, unsightly and unsanitary or allow any icebox, refrigerator, stove, tires, building material, paper, building rubbish to be openly stored, or allow similar unsafe, unsightly and unsanitary. Ord. No. 2009-867.

**Action to be taken:**

Rubbish in yard and overgrown vegetation next to fence must be removed within 7 days.

FAILURE TO CORRECT VIOLATION(S) WILL RESULT IN ISSUANCE OF A COURT SUMMONS TO APPEAR IN DISTRICT COURT. THE MAXIMUM FINE PER COURT SUMMONS IS \$100.00 EACH DAY IS A SEPARATE OFFENSE. THE CLEANUP BEING PERFORMED BY CITY OFFICIALS ON THE PROPERTY WILL RESULT IN PAYMENT AT THE OWNER(S) EXPENSE OF \$100.00 OR TEN PERCENT (10%) OF THE TOTAL COSTS INCURRED BY THE CITY TO REMEDY THE VIOLATION, WHICHEVER IS GREATER, AND AN ADDITION OF THE ACTUAL COST OF THE WORK INVOLVED IN CORRECTING THE CONDITIONS. A LIEN MAY BE FILED AGAINST THE PROPERTY AND AGAINST YOU AS THE OWNER FOR UNPAID FEES.

Thank You,

Office of Code Enforcement





907. Ruby Ave



## Notice of Violation

### City of Osceola

Office of Code Enforcement

303 West Hale Avenue P.O. Box 443

Osceola, AR 72370

Phone (870) 563-5245

Fax (870) 563-5195 or (870) 497-2228



02/04/2022

SEXTON, CLYDE BENJAMIN  
1105 W FORD OSCEOLA AR 72370

Subject Property: 1105 W FORD OSCEOLA AR, , AR

Dear Property Owner:

YOU ARE HEREBY NOTIFIED TO DO THE FOLLOWING TO CORRECT THE VIOLATION(S) INDICATED BELOW:

**5.08.01 Inoperable Vehicles** - It shall be unlawful for the owner, owners, or occupant of any lot or other real property within the City of Osceola, Arkansas to utilize the premises for Commercial and/or open storage of any inoperable motor vehicle. An inoperable motor vehicle for the purpose of this Ordinance, is defined as one that is in a state of disrepair and incapable of being moved under it's own power or one that does not have current, valid license plates. Ord. No. 1993-679.

**5.12.03 Weeds and Grass, Etc., Removal** - Weeds and grass, removal of rubbish, open storage, stagnant water. It shall be unlawful for any person owning and/or occupying any lot or real property within the City of Osceola, Arkansas, to allow weeds to grow thereon to a greater height of more than twelve (12) inches or to become unsightly or unsanitary, or to allow grass, garbage, rubbish, rotting or dead limbs or trees to become unsafe, unsightly and unsanitary or allow any icebox, refrigerator, stove, tires, building material, paper, building rubbish to be openly stored, or allow similar unsafe, unsightly and unsanitary. Ord. No. 2009-867.

**Action to be taken:**

inoperable vehicle in drive way. rubbish in yard and porch. Violations must be corrected within 7 days.

FAILURE TO CORRECT VIOLATION(S) WILL RESULT IN ISSUANCE OF A COURT SUMMONS TO APPEAR IN DISTRICT COURT. THE MAXIMUM FINE PER COURT SUMMONS IS \$100.00 EACH DAY IS A SEPARATE OFFENSE. THE CLEANUP BEING PERFORMED BY CITY OFFICIALS ON THE PROPERTY WILL RESULT IN PAYMENT AT THE OWNER(S) EXPENSE OF \$100.00 OR TEN PERCENT (10%) OF THE TOTAL COSTS INCURRED BY THE CITY TO REMEDY THE VIOLATION, WHICHEVER IS GREATER, AND AN ADDITION OF THE ACTUAL COST OF THE WORK INVOLVED IN CORRECTING THE CONDITIONS. A LIEN MAY BE FILED AGAINST THE PROPERTY AND AGAINST YOU AS THE OWNER FOR UNPAID FEES.

Thank You,

Office of Code Enforcement





~~1105~~ ~~Av Drive~~

1105 W Ford Ave

## Notice of Violation

### City of Osceola

Office of Code Enforcement

303 West Hale Avenue P.O. Box 443

Osceola, AR 72370

Phone (870) 563-5245

Fax (870) 563-5195 or (870) 497-2228



02/04/2022

OUSLEY, ROBERT III  
823 BETTY LYNN OSCEOLA AR 72370

Subject Property: 823 BETTY LYNN OSCEOLA AR, , AR

Dear Property Owner:

YOU ARE HEREBY NOTIFIED TO DO THE FOLLOWING TO CORRECT THE VIOLATION(S) INDICATED BELOW:

**5.08.01 Inoperable Vehicles** - It shall be unlawful for the owner, owners, or occupant of any lot or other real property within the City of Osceola, Arkansas to utilize the premises for Commercial and/or open storage of any inoperable motor vehicle. An inoperable motor vehicle for the purpose of this Ordinance, is defined as one that is in a state of disrepair and incapable of being moved under it's own power or one that does not have current, valid license plates. Ord. No. 1993-679.

**5.12.03 Weeds and Grass, Etc., Removal** - Weeds and grass, removal of rubbish, open storage, stagnant water. It shall be unlawful for any person owning and/or occupying any lot or real property within the City of Osceola, Arkansas, to allow weeds to grow thereon to a greater height of more than twelve (12) inches or to become unsightly or unsanitary, or to allow grass, garbage, rubbish, rotting or dead limbs or trees to become unsafe, unsightly and unsanitary or allow any icebox, refrigerator, stove, tires, building material, paper, building rubbish to be openly stored, or allow similar unsafe, unsightly and unsanitary. Ord. No. 2009-867.

#### Action to be taken:

Rubbish, inoperable cars, and trailers in the street and driveway must be corrected within 7 days.

FAILURE TO CORRECT VIOLATION(S) WILL RESULT IN ISSUANCE OF A COURT SUMMONS TO APPEAR IN DISTRICT COURT. THE MAXIMUM FINE PER COURT SUMMONS IS \$100.00 EACH DAY IS A SEPARATE OFFENSE. THE CLEANUP BEING PERFORMED BY CITY OFFICIALS ON THE PROPERTY WILL RESULT IN PAYMENT AT THE OWNER(S) EXPENSE OF \$100.00 OR TEN PERCENT (10%) OF THE TOTAL COSTS INCURRED BY THE CITY TO REMEDY THE VIOLATION, WHICHEVER IS GREATER, AND AN ADDITION OF THE ACTUAL COST OF THE WORK INVOLVED IN CORRECTING THE CONDITIONS. A LIEN MAY BE FILED AGAINST THE PROPERTY AND AGAINST YOU AS THE OWNER FOR UNPAID FEES.

Thank You,

Office of Code Enforcement





823 Betty Ln





823 Betty Ln



## Notice of Violation

### City of Osceola

Office of Code Enforcement

303 West Hale Avenue P.O. Box 443

Osceola, AR 72370

Phone (870) 563-5245

Fax (870) 563-5195 or (870) 497-2228



A Community United for Progress

02/04/2022

DONALDSON, WILLIAM E II & VERONICA  
1105 NORTH DR OSCEOLA AR 72370

Subject Property: 1105 NORTH DRIVE AR, , AR

Dear Property Owner:

YOU ARE HEREBY NOTIFIED TO DO THE FOLLOWING TO CORRECT THE VIOLATION(S) INDICATED BELOW:

**5.08.01 Inoperable Vehicles** - It shall be unlawful for the owner, owners, or occupant of any lot or other real property within the City of Osceola, Arkansas to utilize the premises for Commercial and/or open storage of any inoperable motor vehicle. An inoperable motor vehicle for the purpose of this Ordinance, is defined as one that is in a state of disrepair and incapable of being moved under it's own power or one that does not have current, valid license plates. Ord. No. 1993-679.

**5.12.03 Weeds and Grass, Etc., Removal** - Weeds and grass, removal of rubbish, open storage, stagnant water. It shall be unlawful for any person owning and/or occupying any lot or real property within the City of Osceola, Arkansas, to allow weeds to grow thereon to a greater height of more than twelve (12) inches or to become unsightly or unsanitary, or to allow grass, garbage, rubbish, rotting or dead limbs or trees to become unsafe, unsightly and unsanitary or allow any icebox, refrigerator, stove, tires, building material, paper, building rubbish to be openly stored, or allow similar unsafe, unsightly and unsanitary. Ord. No. 2009-867.

**Action to be taken:**

Rubbish in yard and inoperable cars in yard. Violations must be corrected within 7 days.

FAILURE TO CORRECT VIOLATION(S) WILL RESULT IN ISSUANCE OF A COURT SUMMONS TO APPEAR IN DISTRICT COURT. THE MAXIMUM FINE PER COURT SUMMONS IS \$100.00 EACH DAY IS A SEPARATE OFFENSE. THE CLEANUP BEING PERFORMED BY CITY OFFICIALS ON THE PROPERTY WILL RESULT IN PAYMENT AT THE OWNER(S) EXPENSE OF \$100.00 OR TEN PERCENT (10%) OF THE TOTAL COSTS INCURRED BY THE CITY TO REMEDY THE VIOLATION, WHICHEVER IS GREATER, AND AN ADDITION OF THE ACTUAL COST OF THE WORK INVOLVED IN CORRECTING THE CONDITIONS. A LIEN MAY BE FILED AGAINST THE PROPERTY AND AGAINST YOU AS THE OWNER FOR UNPAID FEES.

Thank You,

Office of Code Enforcement





1105 N Drive



## Notice of Violation

### City of Osceola

Office of Code Enforcement

303 West Hale Avenue P.O. Box 443

Osceola, AR 72370

Phone (870) 563-5245

Fax (870) 563-5195 or (870) 497-2228



A Community United for Progress

02/04/2022

HOLTHOUSE, KIMBERLY A  
P O BOX 816 OSCEOLA AR 72370

Subject Property: 925 S GARDEN OSCEOLA AR, , AR

Dear Property Owner:

YOU ARE HEREBY NOTIFIED TO DO THE FOLLOWING TO CORRECT THE VIOLATION(S) INDICATED BELOW:

**5.08.01 Inoperable Vehicles** - It shall be unlawful for the owner, owners, or occupant of any lot or other real property within the City of Osceola, Arkansas to utilize the premises for Commercial and/or open storage of any inoperable motor vehicle. An inoperable motor vehicle for the purpose of this Ordinance, is defined as one that is in a state of disrepair and incapable of being moved under it's own power or one that does not have current, valid license plates. Ord. No. 1993-679.

**5.12.03 Weeds and Grass, Etc., Removal** - Weeds and grass, removal of rubbish, open storage, stagnant water. It shall be unlawful for any person owning and/or occupying any lot or real property within the City of Osceola, Arkansas, to allow weeds to grow thereon to a greater height of more than twelve (12) inches or to become unsightly or unsanitary, or to allow grass, garbage, rubbish, rotting or dead limbs or trees to become unsafe, unsightly and unsanitary or allow any icebox, refrigerator, stove, tires, building material, paper, building rubbish to be openly stored, or allow similar unsafe, unsightly and unsanitary. Ord. No. 2009-867.

#### Action to be taken:

Inoperable car in driveway and rubbish in carport and yard. Violations must be corrected within 7 days.

FAILURE TO CORRECT VIOLATION(S) WILL RESULT IN ISSUANCE OF A COURT SUMMONS TO APPEAR IN DISTRICT COURT. THE MAXIMUM FINE PER COURT SUMMONS IS \$100.00 EACH DAY IS A SEPARATE OFFENSE. THE CLEANUP BEING PERFORMED BY CITY OFFICIALS ON THE PROPERTY WILL RESULT IN PAYMENT AT THE OWNER(S) EXPENSE OF \$100.00 OR TEN PERCENT (10%) OF THE TOTAL COSTS INCURRED BY THE CITY TO REMEDY THE VIOLATION, WHICHEVER IS GREATER, AND AN ADDITION OF THE ACTUAL COST OF THE WORK INVOLVED IN CORRECTING THE CONDITIONS. A LIEN MAY BE FILED AGAINST THE PROPERTY AND AGAINST YOU AS THE OWNER FOR UNPAID FEES.

Thank You,

Office of Code Enforcement



925 S Garden Dr



## Notice of Violation

### City of Osceola

Office of Code Enforcement

303 West Hale Avenue P.O. Box 443

Osceola, AR 72370

Phone (870) 563-5245

Fax (870) 563-5195 or (870) 497-2228



02/04/2022

THOMAS, JIMMY W

126 CARRIAGE DRIVE OSCEOLA AR 72370

Subject Property: 158 W CIRCLE OSCEOLA AR, , AR

Dear Property Owner:

YOU ARE HEREBY NOTIFIED TO DO THE FOLLOWING TO CORRECT THE VIOLATION(S) INDICATED BELOW:

**5.08.01 Inoperable Vehicles** - It shall be unlawful for the owner, owners, or occupant of any lot or other real property within the City of Osceola, Arkansas to utilize the premises for Commercial and/or open storage of any inoperable motor vehicle. An inoperable motor vehicle for the purpose of this Ordinance, is defined as one that is in a state of disrepair and incapable of being moved under it's own power or one that does not have current, valid license plates. Ord. No. 1993-679.

**5.12.03 Weeds and Grass, Etc., Removal** - Weeds and grass, removal of rubbish, open storage, stagnant water. It shall be unlawful for any person owning and/or occupying any lot or real property within the City of Osceola, Arkansas, to allow weeds to grow thereon to a greater height of more than twelve (12) inches or to become unsightly or unsanitary, or to allow grass, garbage, rubbish, rotting or dead limbs or trees to become unsafe, unsightly and unsanitary or allow any icebox, refrigerator, stove, tires, building material, paper, building rubbish to be openly stored, or allow similar unsafe, unsightly and unsanitary. Ord. No. 2009-867.

**Action to be taken:**

Violations must be corrected within 7 days. Remove rubbish from front porch and yard.

FAILURE TO CORRECT VIOLATION(S) WILL RESULT IN ISSUANCE OF A COURT SUMMONS TO APPEAR IN DISTRICT COURT. THE MAXIMUM FINE PER COURT SUMMONS IS \$100.00 EACH DAY IS A SEPARATE OFFENSE. THE CLEANUP BEING PERFORMED BY CITY OFFICIALS ON THE PROPERTY WILL RESULT IN PAYMENT AT THE OWNER(S) EXPENSE OF \$100.00 OR TEN PERCENT (10%) OF THE TOTAL COSTS INCURRED BY THE CITY TO REMEDY THE VIOLATION, WHICHEVER IS GREATER, AND AN ADDITION OF THE ACTUAL COST OF THE WORK INVOLVED IN CORRECTING THE CONDITIONS. A LIEN MAY BE FILED AGAINST THE PROPERTY AND AGAINST YOU AS THE OWNER FOR UNPAID FEES.

Thank You,

Office of Code Enforcement



158 W Circle Dr



## Notice of Violation

### City of Osceola

Office of Code Enforcement

303 West Hale Avenue P.O. Box 443

Osceola, AR 72370

Phone (870) 563-5245

Fax (870) 563-5195 or (870) 497-2228



A Community United for Progress

02/04/2022

RICHARDSON, BETTY  
PO BOX MONETTE MONETTE AR 72447

*Kathy Childress*

Subject Property: 150 W CIRCLE OSCEOLA AR, , AR

Dear Property Owner:

YOU ARE HEREBY NOTIFIED TO DO THE FOLLOWING TO CORRECT THE VIOLATION(S) INDICATED BELOW:

**5.08.01 Inoperable Vehicles** - It shall be unlawful for the owner, owners, or occupant of any lot or other real property within the City of Osceola, Arkansas to utilize the premises for Commercial and/or open storage of any inoperable motor vehicle. An inoperable motor vehicle for the purpose of this Ordinance, is defined as one that is in a state of disrepair and incapable of being moved under it's own power or one that does not have current, valid license plates. Ord. No. 1993-679.

**5.12.03 Weeds and Grass, Etc., Removal** - Weeds and grass, removal of rubbish, open storage, stagnant water. It shall be unlawful for any person owning and/or occupying any lot or real property within the City of Osceola, Arkansas, to allow weeds to grow thereon to a greater height of more than twelve (12) inches or to become unsightly or unsanitary, or to allow grass, garbage, rubbish, rotting or dead limbs or trees to become unsafe, unsightly and unsanitary or allow any icebox, refrigerator, stove, tires, building material, paper, building rubbish to be openly stored, or allow similar unsafe, unsightly and unsanitary. Ord. No. 2009-867.

#### Action to be taken:

Inoperable Cars and rubbish in yard. Violations must be corrected within 7 days.

FAILURE TO CORRECT VIOLATION(S) WILL RESULT IN ISSUANCE OF A COURT SUMMONS TO APPEAR IN DISTRICT COURT. THE MAXIMUM FINE PER COURT SUMMONS IS \$100.00 EACH DAY IS A SEPARATE OFFENSE. THE CLEANUP BEING PERFORMED BY CITY OFFICIALS ON THE PROPERTY WILL RESULT IN PAYMENT AT THE OWNER(S) EXPENSE OF \$100.00 OR TEN PERCENT (10%) OF THE TOTAL COSTS INCURRED BY THE CITY TO REMEDY THE VIOLATION, WHICHEVER IS GREATER, AND AN ADDITION OF THE ACTUAL COST OF THE WORK INVOLVED IN CORRECTING THE CONDITIONS. A LIEN MAY BE FILED AGAINST THE PROPERTY AND AGAINST YOU AS THE OWNER FOR UNPAID FEES.

Thank You,

Office of Code Enforcement





150 W Circle Dr



## Notice of Violation

### City of Osceola

Office of Code Enforcement

303 West Hale Avenue P.O. Box 443

Osceola, AR 72370

Phone (870) 563-5245

Fax (870) 563-5195 or (870) 497-2228



02/04/2022

JOPLIN, MICHAEL R

148 W CIRCLE DR OSCEOLA AR 72370

Subject Property: 148 W CIRCLE OSCEOLA AR, , AR

Dear Property Owner:

YOU ARE HEREBY NOTIFIED TO DO THE FOLLOWING TO CORRECT THE VIOLATION(S) INDICATED BELOW:

**5.08.01 Inoperable Vehicles** - It shall be unlawful for the owner, owners, or occupant of any lot or other real property within the City of Osceola, Arkansas to utilize the premises for Commercial and/or open storage of any inoperable motor vehicle. An inoperable motor vehicle for the purpose of this Ordinance, is defined as one that is in a state of disrepair and incapable of being moved under it's own power or one that does not have current, valid license plates. Ord. No. 1993-679.

**5.12.03 Weeds and Grass, Etc., Removal** - Weeds and grass, removal of rubbish, open storage, stagnant water. It shall be unlawful for any person owning and/or occupying any lot or real property within the City of Osceola, Arkansas, to allow weeds to grow thereon to a greater height of more than twelve (12) inches or to become unsightly or unsanitary, or to allow grass, garbage, rubbish, rotting or dead limbs or trees to become unsafe, unsightly and unsanitary or allow any icebox, refrigerator, stove, tires, building material, paper, building rubbish to be openly stored, or allow similar unsafe, unsightly and unsanitary. Ord. No. 2009-867.

**Action to be taken:**

inoperable cars and rubbish in yard. Violations must be corrected within 7 days.

FAILURE TO CORRECT VIOLATION(S) WILL RESULT IN ISSUANCE OF A COURT SUMMONS TO APPEAR IN DISTRICT COURT. THE MAXIMUM FINE PER COURT SUMMONS IS \$100.00 EACH DAY IS A SEPARATE OFFENSE. THE CLEANUP BEING PERFORMED BY CITY OFFICIALS ON THE PROPERTY WILL RESULT IN PAYMENT AT THE OWNER(S) EXPENSE OF \$100.00 OR TEN PERCENT (10%) OF THE TOTAL COSTS INCURRED BY THE CITY TO REMEDY THE VIOLATION, WHICHEVER IS GREATER, AND AN ADDITION OF THE ACTUAL COST OF THE WORK INVOLVED IN CORRECTING THE CONDITIONS. A LIEN MAY BE FILED AGAINST THE PROPERTY AND AGAINST YOU AS THE OWNER FOR UNPAID FEES.

Thank You,

Office of Code Enforcement



148 W Circle Dr



## Notice of Violation

### City of Osceola

Office of Code Enforcement

303 West Hale Avenue P.O. Box 443

Osceola, AR 72370

Phone (870) 563-5245

Fax (870) 563-5195 or (870) 497-2228



02/04/2022

MOORE, DEBRA F

142 W CIRCLE DR OSCEOLA AR 72370

Subject Property: 142 W CIRCLE AR, , AR

Dear Property Owner:

YOU ARE HEREBY NOTIFIED TO DO THE FOLLOWING TO CORRECT THE VIOLATION(S) INDICATED BELOW:

**5.12.03 Weeds and Grass, Etc., Removal** - Weeds and grass, removal of rubbish, open storage, stagnant water. It shall be unlawful for any person owning and/or occupying any lot or real property within the City of Osceola, Arkansas, to allow weeds to grow thereon to a greater height of more than twelve (12) inches or to become unsightly or unsanitary, or to allow grass, garbage, rubbish, rotting or dead limbs or trees to become unsafe, unsightly and unsanitary or allow any icebox, refrigerator, stove, tires, building material, paper, building rubbish to be openly stored, or allow similar unsafe, unsightly and unsanitary. Ord. No. 2009-867.

**Action to be taken:**

rubbish and building materials in yard must be removed within 7 days.

FAILURE TO CORRECT VIOLATION(S) WILL RESULT IN ISSUANCE OF A COURT SUMMONS TO APPEAR IN DISTRICT COURT. THE MAXIMUM FINE PER COURT SUMMONS IS \$100.00 EACH DAY IS A SEPARATE OFFENSE. THE CLEANUP BEING PERFORMED BY CITY OFFICIALS ON THE PROPERTY WILL RESULT IN PAYMENT AT THE OWNER(S) EXPENSE OF \$100.00 OR TEN PERCENT (10%) OF THE TOTAL COSTS INCURRED BY THE CITY TO REMEDY THE VIOLATION, WHICHEVER IS GREATER, AND AN ADDITION OF THE ACTUAL COST OF THE WORK INVOLVED IN CORRECTING THE CONDITIONS. A LIEN MAY BE FILED AGAINST THE PROPERTY AND AGAINST YOU AS THE OWNER FOR UNPAID FEES.

Thank You,

Office of Code Enforcement



142 W Circle Dr



## Notice of Violation

### City of Osceola

Office of Code Enforcement

303 West Hale Avenue P.O. Box 443

Osceola, AR 72370

Phone (870) 563-5245

Fax (870) 563-5195 or (870) 497-2228



A Community United for Progress

02/04/2022

OGLE, STEPHANIE

101 CHERRY DR OSCEOLA AR 72370

Subject Property: 101 CHERRY OSCEOLA AR, , AR

Dear Property Owner:

YOU ARE HEREBY NOTIFIED TO DO THE FOLLOWING TO CORRECT THE VIOLATION(S) INDICATED BELOW:

**5.12.03 Weeds and Grass, Etc., Removal** - Weeds and grass, removal of rubbish, open storage, stagnant water. It shall be unlawful for any person owning and/or occupying any lot or real property within the City of Osceola, Arkansas, to allow weeds to grow thereon to a greater height of more than twelve (12) inches or to become unsightly or unsanitary, or to allow grass, garbage, rubbish, rotting or dead limbs or trees to become unsafe, unsightly and unsanitary or allow any icebox, refrigerator, stove, tires, building material, paper, building rubbish to be openly stored, or allow similar unsafe, unsightly and unsanitary. Ord. No. 2009-867.

**Action to be taken:**

Tires and rubbish in yard. Violation must be corrected within 7 days.

FAILURE TO CORRECT VIOLATION(S) WILL RESULT IN ISSUANCE OF A COURT SUMMONS TO APPEAR IN DISTRICT COURT. THE MAXIMUM FINE PER COURT SUMMONS IS \$100.00 EACH DAY IS A SEPARATE OFFENSE. THE CLEANUP BEING PERFORMED BY CITY OFFICIALS ON THE PROPERTY WILL RESULT IN PAYMENT AT THE OWNER(S) EXPENSE OF \$100.00 OR TEN PERCENT (10%) OF THE TOTAL COSTS INCURRED BY THE CITY TO REMEDY THE VIOLATION, WHICHEVER IS GREATER, AND AN ADDITION OF THE ACTUAL COST OF THE WORK INVOLVED IN CORRECTING THE CONDITIONS. A LIEN MAY BE FILED AGAINST THE PROPERTY AND AGAINST YOU AS THE OWNER FOR UNPAID FEES.

Thank You,

Office of Code Enforcement



101 Cherry Dr



## Notice of Violation

### City of Osceola

Office of Code Enforcement

303 West Hale Avenue P.O. Box 443

Osceola, AR 72370

Phone (870) 563-5245

Fax (870) 563-5195 or (870) 497-2228



A Community United for Progress

02/04/2022

B & A WRIGHT PROPERTIES, INC  
810 BETTY LYNN OSCEOLA AR 72370

*Joshua Jackson*  
Subject Property: 104 CHERRY AR, , AR

Dear Property Owner:

YOU ARE HEREBY NOTIFIED TO DO THE FOLLOWING TO CORRECT THE VIOLATION(S) INDICATED BELOW:

**5.12.03 Weeds and Grass, Etc., Removal** - Weeds and grass, removal of rubbish, open storage, stagnant water. It shall be unlawful for any person owning and/or occupying any lot or real property within the City of Osceola, Arkansas, to allow weeds to grow thereon to a greater height of more than twelve (12) inches or to become unsightly or unsanitary, or to allow grass, garbage, rubbish, rotting or dead limbs or trees to become unsafe, unsightly and unsanitary or allow any icebox, refrigerator, stove, tires, building material, paper, building rubbish to be openly stored, or allow similar unsafe, unsightly and unsanitary. Ord. No. 2009-867.

**Action to be taken:**

Rubbish in driveway and yard. Violations must be addressed within 7 days.

FAILURE TO CORRECT VIOLATION(S) WILL RESULT IN ISSUANCE OF A COURT SUMMONS TO APPEAR IN DISTRICT COURT. THE MAXIMUM FINE PER COURT SUMMONS IS \$100.00 EACH DAY IS A SEPARATE OFFENSE. THE CLEANUP BEING PERFORMED BY CITY OFFICIALS ON THE PROPERTY WILL RESULT IN PAYMENT AT THE OWNER(S) EXPENSE OF \$100.00 OR TEN PERCENT (10%) OF THE TOTAL COSTS INCURRED BY THE CITY TO REMEDY THE VIOLATION, WHICHEVER IS GREATER, AND AN ADDITION OF THE ACTUAL COST OF THE WORK INVOLVED IN CORRECTING THE CONDITIONS. A LIEN MAY BE FILED AGAINST THE PROPERTY AND AGAINST YOU AS THE OWNER FOR UNPAID FEES.

Thank You,

Office of Code Enforcement



104 Cherry Dr



## Notice of Violation

### City of Osceola

Office of Code Enforcement

303 West Hale Avenue P.O. Box 443

Osceola, AR 72370

Phone (870) 563-5245

Fax (870) 563-5195 or (870) 497-2228



02/04/2022

B & A WRIGHT PROPERTIES, INS  
810 BETTY LYNN OSCEOLA AR 72370

*Joe Danton Jr.*  
Subject Property: 135 CHERRY OSCEOLA AR, , AR

Dear Property Owner:

YOU ARE HEREBY NOTIFIED TO DO THE FOLLOWING TO CORRECT THE VIOLATION(S) INDICATED BELOW:

**5.08.01 Inoperable Vehicles** - It shall be unlawful for the owner, owners, or occupant of any lot or other real property within the City of Osceola, Arkansas to utilize the premises for Commercial and/or open storage of any inoperable motor vehicle. An inoperable motor vehicle for the purpose of this Ordinance, is defined as one that is in a state of disrepair and incapable of being moved under it's own power or one that does not have current, valid license plates. Ord. No. 1993-679.

**Action to be taken:**

Violation must be corrected within 7 days.

FAILURE TO CORRECT VIOLATION(S) WILL RESULT IN ISSUANCE OF A COURT SUMMONS TO APPEAR IN DISTRICT COURT. THE MAXIMUM FINE PER COURT SUMMONS IS \$100.00 EACH DAY IS A SEPARATE OFFENSE. THE CLEANUP BEING PERFORMED BY CITY OFFICIALS ON THE PROPERTY WILL RESULT IN PAYMENT AT THE OWNER(S) EXPENSE OF \$100.00 OR TEN PERCENT (10%) OF THE TOTAL COSTS INCURRED BY THE CITY TO REMEDY THE VIOLATION, WHICHEVER IS GREATER, AND AN ADDITION OF THE ACTUAL COST OF THE WORK INVOLVED IN CORRECTING THE CONDITIONS. A LIEN MAY BE FILED AGAINST THE PROPERTY AND AGAINST YOU AS THE OWNER FOR UNPAID FEES.

Thank You,

Office of Code Enforcement



135 Cherry Dr



## Notice of Violation

### City of Osceola

Office of Code Enforcement

303 West Hale Avenue P.O. Box 443

Osceola, AR 72370

Phone (870) 563-5245

Fax (870) 563-5195 or (870) 497-2228



02/04/2022

BROWN, DEAN & PATTY or James McCormick  
101 MIMOSA OSCEOLA AR 72370

Subject Property: 101 MIMOSA AR, , AR

Dear Property Owner:

YOU ARE HEREBY NOTIFIED TO DO THE FOLLOWING TO CORRECT THE VIOLATION(S) INDICATED BELOW:

**5.08.02 Inoperable Vehicles Removal** - Any inoperable vehicle located on a vacant lot or unoccupied real property within the City of Osceola shall, after and attempt to locate the owner, shall be ordered removed by the Chief of Police and disposed of by the means provided by law. Ord. No. 1993-679.

**5.12.03 Weeds and Grass, Etc., Removal** - Weeds and grass, removal of rubbish, open storage, stagnant water. It shall be unlawful for any person owning and/or occupying any lot or real property within the City of Osceola, Arkansas, to allow weeds to grow thereon to a greater height of more than twelve (12) inches or to become unsightly or unsanitary, or to allow grass, garbage, rubbish, rotting or dead limbs or trees to become unsafe, unsightly and unsanitary or allow any icebox, refrigerator, stove, tires, building material, paper, building rubbish to be openly stored, or allow similar unsafe, unsightly and unsanitary. Ord. No. 2009-867.

**Action to be taken:**

Violations must be corrected within 7 days. Remove rubbish and litter from yard. Boats cannot be parked on front lawn.

FAILURE TO CORRECT VIOLATION(S) WILL RESULT IN ISSUANCE OF A COURT SUMMONS TO APPEAR IN DISTRICT COURT. THE MAXIMUM FINE PER COURT SUMMONS IS \$100.00 EACH DAY IS A SEPARATE OFFENSE. THE CLEANUP BEING PERFORMED BY CITY OFFICIALS ON THE PROPERTY WILL RESULT IN PAYMENT AT THE OWNER(S) EXPENSE OF \$100.00 OR TEN PERCENT (10%) OF THE TOTAL COSTS INCURRED BY THE CITY TO REMEDY THE VIOLATION, WHICHEVER IS GREATER, AND AN ADDITION OF THE ACTUAL COST OF THE WORK INVOLVED IN CORRECTING THE CONDITIONS. A LIEN MAY BE FILED AGAINST THE PROPERTY AND AGAINST YOU AS THE OWNER FOR UNPAID FEES.

Thank You,

Office of Code Enforcement





101 Mimosa





101 Nimrod





101 Mimosa



## Notice of Violation

### City of Osceola

Office of Code Enforcement

303 West Hale Avenue P.O. Box 443

Osceola, AR 72370

Phone (870) 563-5245

Fax (870) 563-5195 or (870) 497-2228



02/04/2022

Jimmy Tribble  
211 CHERRY  
Osceola, Arkansas 72370

Subject Property: 211 CHERRY , Osceola, AR

Dear Property Owner:

YOU ARE HEREBY NOTIFIED TO DO THE FOLLOWING TO CORRECT THE VIOLATION(S) INDICATED BELOW:

**5.12.03 Weeds and Grass, Etc., Removal** - Weeds and grass, removal of rubbish, open storage, stagnant water. It shall be unlawful for any person owning and/or occupying any lot or real property within the City of Osceola, Arkansas, to allow weeds to grow thereon to a greater height of more than twelve (12) inches or to become unsightly or unsanitary, or to allow grass, garbage, rubbish, rotting or dead limbs or trees to become unsafe, unsightly and unsanitary or allow any icebox, refrigerator, stove, tires, building material, paper, building rubbish to be openly stored, or allow similar unsafe, unsightly and unsanitary. Ord. No. 2009-867.

#### Action to be taken:

Rubbish in front yard. Violation must be corrected within 7 days.

FAILURE TO CORRECT VIOLATION(S) WILL RESULT IN ISSUANCE OF A COURT SUMMONS TO APPEAR IN DISTRICT COURT. THE MAXIMUM FINE PER COURT SUMMONS IS \$100.00 EACH DAY IS A SEPARATE OFFENSE. THE CLEANUP BEING PERFORMED BY CITY OFFICIALS ON THE PROPERTY WILL RESULT IN PAYMENT AT THE OWNER(S) EXPENSE OF \$100.00 OR TEN PERCENT (10%) OF THE TOTAL COSTS INCURRED BY THE CITY TO REMEDY THE VIOLATION, WHICHEVER IS GREATER, AND AN ADDITION OF THE ACTUAL COST OF THE WORK INVOLVED IN CORRECTING THE CONDITIONS. A LIEN MAY BE FILED AGAINST THE PROPERTY AND AGAINST YOU AS THE OWNER FOR UNPAID FEES.

Thank You,

Office of Code Enforcement



211 Cherry Dr



## Notice of Violation

### City of Osceola

Office of Code Enforcement

303 West Hale Avenue P.O. Box 443

Osceola, AR 72370

Phone (870) 563-5245

Fax (870) 563-5195 or (870) 497-2228



02/04/2022

KEYS, W. DAVID

P O BOX 423 MANILA AR 72442-0423

Subject Property: 138 W CIRCLE AR, , AR

Dear Property Owner:

YOU ARE HEREBY NOTIFIED TO DO THE FOLLOWING TO CORRECT THE VIOLATION(S) INDICATED BELOW:

**5.04.01 Property Maintenance** - It shall be unlawful for the owner, owners or occupant of any lot or other real property within the City of Osceola, Arkansas to maintain or allow any dilapidated or unsightly building or structure on such lot or real property. Ord. No. 1991-650.

**5.12.03 Weeds and Grass, Etc., Removal** - Weeds and grass, removal of rubbish, open storage, stagnant water. It shall be unlawful for any person owning and/or occupying any lot or real property within the City of Osceola, Arkansas, to allow weeds to grow thereon to a greater height of more than twelve (12) inches or to become unsightly or unsanitary, or to allow grass, garbage, rubbish, rotting or dead limbs or trees to become unsafe, unsightly and unsanitary or allow any icebox, refrigerator, stove, tires, building material, paper, building rubbish to be openly stored, or allow similar unsafe, unsightly and unsanitary. Ord. No. 2009-867.

**Action to be taken:**

Violations must be corrected within 30 days.

FAILURE TO CORRECT VIOLATION(S) WILL RESULT IN ISSUANCE OF A COURT SUMMONS TO APPEAR IN DISTRICT COURT. THE MAXIMUM FINE PER COURT SUMMONS IS \$100.00 EACH DAY IS A SEPARATE OFFENSE. THE CLEANUP BEING PERFORMED BY CITY OFFICIALS ON THE PROPERTY WILL RESULT IN PAYMENT AT THE OWNER(S) EXPENSE OF \$100.00 OR TEN PERCENT (10%) OF THE TOTAL COSTS INCURRED BY THE CITY TO REMEDY THE VIOLATION, WHICHEVER IS GREATER, AND AN ADDITION OF THE ACTUAL COST OF THE WORK INVOLVED IN CORRECTING THE CONDITIONS. A LIEN MAY BE FILED AGAINST THE PROPERTY AND AGAINST YOU AS THE OWNER FOR UNPAID FEES.

Thank You,

Office of Code Enforcement





138 w circle D



## Notice of Violation

### City of Osceola

Office of Code Enforcement

303 West Hale Avenue P.O. Box 443

Osceola, AR 72370

Phone (870) 563-5245

Fax (870) 563-5195 or (870) 497-2228



A Community United for Progress

02/04/2022

GONZALEZ, JAMES O JR

9023 N PEARL OSCEOLA AR 72370

*Jasmine Vande*

Subject Property: 100 CHERRY OSCEOLA AR, , AR

Dear Property Owner:

YOU ARE HEREBY NOTIFIED TO DO THE FOLLOWING TO CORRECT THE VIOLATION(S) INDICATED BELOW:

**5.12.03 Weeds and Grass, Etc., Removal** - Weeds and grass, removal of rubbish, open storage, stagnant water. It shall be unlawful for any person owning and/or occupying any lot or real property within the City of Osceola, Arkansas, to allow weeds to grow thereon to a greater height of more than twelve (12) inches or to become unsightly or unsanitary, or to allow grass, garbage, rubbish, rotting or dead limbs or trees to become unsafe, unsightly and unsanitary or allow any icebox, refrigerator, stove, tires, building material, paper, building rubbish to be openly stored, or allow similar unsafe, unsightly and unsanitary. Ord. No. 2009-867.

#### Action to be taken:

Rubbish on front porch, front yard and back yard. Violation must be corrected within 7 days.

FAILURE TO CORRECT VIOLATION(S) WILL RESULT IN ISSUANCE OF A COURT SUMMONS TO APPEAR IN DISTRICT COURT. THE MAXIMUM FINE PER COURT SUMMONS IS \$100.00 EACH DAY IS A SEPARATE OFFENSE. THE CLEANUP BEING PERFORMED BY CITY OFFICIALS ON THE PROPERTY WILL RESULT IN PAYMENT AT THE OWNER(S) EXPENSE OF \$100.00 OR TEN PERCENT (10%) OF THE TOTAL COSTS INCURRED BY THE CITY TO REMEDY THE VIOLATION, WHICHEVER IS GREATER, AND AN ADDITION OF THE ACTUAL COST OF THE WORK INVOLVED IN CORRECTING THE CONDITIONS. A LIEN MAY BE FILED AGAINST THE PROPERTY AND AGAINST YOU AS THE OWNER FOR UNPAID FEES.

Thank You,

Office of Code Enforcement



100 Cherry Dr



## Notice of Violation

### City of Osceola

Office of Code Enforcement

303 West Hale Avenue P.O. Box 443

Osceola, AR 72370

Phone (870) 563-5245

Fax (870) 563-5195 or (870) 497-2228



02/04/2022

YORK, JOHN A & DONNA S  
114 CHERRY DR OSCEOLA AR 72370

Subject Property: 114 CHERRY AR, , AR

Dear Property Owner:

YOU ARE HEREBY NOTIFIED TO DO THE FOLLOWING TO CORRECT THE VIOLATION(S) INDICATED BELOW:

**5.08.01 Inoperable Vehicles** - It shall be unlawful for the owner, owners, or occupant of any lot or other real property within the City of Osceola, Arkansas to utilize the premises for Commercial and/or open storage of any inoperable motor vehicle. An inoperable motor vehicle for the purpose of this Ordinance, is defined as one that is in a state of disrepair and incapable of being moved under it's own power or one that does not have current, valid license plates. Ord. No. 1993-679.

**5.12.03 Weeds and Grass, Etc., Removal** - Weeds and grass, removal of rubbish, open storage, stagnant water. It shall be unlawful for any person owning and/or occupying any lot or real property within the City of Osceola, Arkansas, to allow weeds to grow thereon to a greater height of more than twelve (12) inches or to become unsightly or unsanitary, or to allow grass, garbage, rubbish, rotting or dead limbs or trees to become unsafe, unsightly and unsanitary or allow any icebox, refrigerator, stove, tires, building material, paper, building rubbish to be openly stored, or allow similar unsafe, unsightly and unsanitary. Ord. No. 2009-867.

**Action to be taken:**

Tires, rubbish, and camper must be addressed. Violations must be corrected within 7 days.

FAILURE TO CORRECT VIOLATION(S) WILL RESULT IN ISSUANCE OF A COURT SUMMONS TO APPEAR IN DISTRICT COURT. THE MAXIMUM FINE PER COURT SUMMONS IS \$100.00 EACH DAY IS A SEPARATE OFFENSE. THE CLEANUP BEING PERFORMED BY CITY OFFICIALS ON THE PROPERTY WILL RESULT IN PAYMENT AT THE OWNER(S) EXPENSE OF \$100.00 OR TEN PERCENT (10%) OF THE TOTAL COSTS INCURRED BY THE CITY TO REMEDY THE VIOLATION, WHICHEVER IS GREATER, AND AN ADDITION OF THE ACTUAL COST OF THE WORK INVOLVED IN CORRECTING THE CONDITIONS. A LIEN MAY BE FILED AGAINST THE PROPERTY AND AGAINST YOU AS THE OWNER FOR UNPAID FEES.

Thank You,

Office of Code Enforcement





114 Cherry Dr



## Notice of Violation

### City of Osceola

Office of Code Enforcement

303 West Hale Avenue P.O. Box 443

Osceola, AR 72370

Phone (870) 563-5245

Fax (870) 563-5195 or (870) 497-2228



02/04/2022

William Driuer

153 Cherry

Osceola, Arkansas 72370

Subject Property: 153 CHERRY , Osceola, AR

Dear Property Owner:

YOU ARE HEREBY NOTIFIED TO DO THE FOLLOWING TO CORRECT THE VIOLATION(S) INDICATED BELOW:

**5.12.03 Weeds and Grass, Etc., Removal** - Weeds and grass, removal of rubbish, open storage, stagnant water. It shall be unlawful for any person owning and/or occupying any lot or real property within the City of Osceola, Arkansas, to allow weeds to grow thereon to a greater height of more than twelve (12) inches or to become unsightly or unsanitary, or to allow grass, garbage, rubbish, rotting or dead limbs or trees to become unsafe, unsightly and unsanitary or allow any icebox, refrigerator, stove, tires, building material, paper, building rubbish to be openly stored, or allow similar unsafe, unsightly and unsanitary. Ord. No. 2009-867.

**Action to be taken:**

Violations must be corrected within 7 days.

FAILURE TO CORRECT VIOLATION(S) WILL RESULT IN ISSUANCE OF A COURT SUMMONS TO APPEAR IN DISTRICT COURT. THE MAXIMUM FINE PER COURT SUMMONS IS \$100.00 EACH DAY IS A SEPARATE OFFENSE. THE CLEANUP BEING PERFORMED BY CITY OFFICIALS ON THE PROPERTY WILL RESULT IN PAYMENT AT THE OWNER(S) EXPENSE OF \$100.00 OR TEN PERCENT (10%) OF THE TOTAL COSTS INCURRED BY THE CITY TO REMEDY THE VIOLATION, WHICHEVER IS GREATER, AND AN ADDITION OF THE ACTUAL COST OF THE WORK INVOLVED IN CORRECTING THE CONDITIONS. A LIEN MAY BE FILED AGAINST THE PROPERTY AND AGAINST YOU AS THE OWNER FOR UNPAID FEES.

Thank You,

Office of Code Enforcement



153 Cherry Dr



## Notice of Violation

### City of Osceola

Office of Code Enforcement

303 West Hale Avenue P.O. Box 443

Osceola, AR 72370

Phone (870) 563-5245

Fax (870) 563-5195 or (870) 497-2228



02/04/2022

CRAFTON, LINDA D & DANNY  
201 MIMOSA DR OSCEOLA AR 72370

Subject Property: 201 MIMOSA AR, , AR

Dear Property Owner:

YOU ARE HEREBY NOTIFIED TO DO THE FOLLOWING TO CORRECT THE VIOLATION(S) INDICATED BELOW:

**5.12.03 Weeds and Grass, Etc., Removal** - Weeds and grass, **removal of rubbish**, open storage, stagnant water. It shall be unlawful for any person owning and/or occupying any lot or real property within the City of Osceola, Arkansas, to allow weeds to grow thereon to a greater height of more than twelve (12) inches or to become unsightly or unsanitary, or to allow grass, garbage, rubbish, rotting or dead limbs or trees to become unsafe, unsightly and unsanitary or allow any icebox, refrigerator, stove, tires, building material, paper, building rubbish to be openly stored, or allow similar unsafe, unsightly and unsanitary. Ord. No. 2009-867.

**Action to be taken:**

Violation must be corrected within 7 days. Rubbish in front yard.

FAILURE TO CORRECT VIOLATION(S) WILL RESULT IN ISSUANCE OF A COURT SUMMONS TO APPEAR IN DISTRICT COURT. THE MAXIMUM FINE PER COURT SUMMONS IS \$100.00 EACH DAY IS A SEPARATE OFFENSE. THE CLEANUP BEING PERFORMED BY CITY OFFICIALS ON THE PROPERTY WILL RESULT IN PAYMENT AT THE OWNER(S) EXPENSE OF \$100.00 OR TEN PERCENT (10%) OF THE TOTAL COSTS INCURRED BY THE CITY TO REMEDY THE VIOLATION, WHICHEVER IS GREATER, AND AN ADDITION OF THE ACTUAL COST OF THE WORK INVOLVED IN CORRECTING THE CONDITIONS. A LIEN MAY BE FILED AGAINST THE PROPERTY AND AGAINST YOU AS THE OWNER FOR UNPAID FEES.

Thank You,

Office of Code Enforcement



201 Mimosq



## Notice of Violation

### City of Osceola

Office of Code Enforcement

303 West Hale Avenue P.O. Box 443

Osceola, AR 72370

Phone (870) 563-5245

Fax (870) 563-5195 or (870) 497-2228



A Community United for Progress

02/04/2022

NEWELL, JOHN C & MILDRED  
147 MOCKINGBIRD OSCEOLA AR 72370

Subject Property: 147 MOCKINGBIRD OSCEOLA AR, , AR

Dear Property Owner:

YOU ARE HEREBY NOTIFIED TO DO THE FOLLOWING TO CORRECT THE VIOLATION(S) INDICATED BELOW:

**5.12.03 Weeds and Grass, Etc., Removal** - Weeds and grass, removal of rubbish, open storage, stagnant water. It shall be unlawful for any person owning and/or occupying any lot or real property within the City of Osceola, Arkansas, to allow weeds to grow thereon to a greater height of more than twelve (12) inches or to become unsightly or unsanitary, or to allow grass, garbage, rubbish, rotting or dead limbs or trees to become unsafe, unsightly and unsanitary or allow any icebox, refrigerator, stove, tires, building material, paper, building rubbish to be openly stored, or allow similar unsafe, unsightly and unsanitary. Ord. No. 2009-867.

**Action to be taken:**

Violation need to be corrected within 7 days.

FAILURE TO CORRECT VIOLATION(S) WILL RESULT IN ISSUANCE OF A COURT SUMMONS TO APPEAR IN DISTRICT COURT. THE MAXIMUM FINE PER COURT SUMMONS IS \$100.00 EACH DAY IS A SEPARATE OFFENSE. THE CLEANUP BEING PERFORMED BY CITY OFFICIALS ON THE PROPERTY WILL RESULT IN PAYMENT AT THE OWNER(S) EXPENSE OF \$100.00 OR TEN PERCENT (10%) OF THE TOTAL COSTS INCURRED BY THE CITY TO REMEDY THE VIOLATION, WHICHEVER IS GREATER, AND AN ADDITION OF THE ACTUAL COST OF THE WORK INVOLVED IN CORRECTING THE CONDITIONS. A LIEN MAY BE FILED AGAINST THE PROPERTY AND AGAINST YOU AS THE OWNER FOR UNPAID FEES.

Thank You,

Office of Code Enforcement





147 Mockingbird Ln



## Notice of Violation

### City of Osceola

Office of Code Enforcement

303 West Hale Avenue P.O. Box 443

Osceola, AR 72370

Phone (870) 563-5245

Fax (870) 563-5195 or (870) 497-2228



02/04/2022

Christine Harris

109 Diane Dr

Osceola, Arkansas 72370

Subject Property: 109 Diane Dr, Osceola, Arkansas

Dear Property Owner:

YOU ARE HEREBY NOTIFIED TO DO THE FOLLOWING TO CORRECT THE VIOLATION(S) INDICATED BELOW:

**5.12.03 Weeds and Grass, Etc., Removal** - Weeds and grass, removal of rubbish, open storage, stagnant water. It shall be unlawful for any person owning and/or occupying any lot or real property within the City of Osceola, Arkansas, to allow weeds to grow thereon to a greater height of more than twelve (12) inches or to become unsightly or unsanitary, or to allow grass, garbage, rubbish, rotting or dead limbs or trees to become unsafe, unsightly and unsanitary or allow any icebox, refrigerator, stove, tires, building material, paper, building rubbish to be openly stored, or allow similar unsafe, unsightly and unsanitary. Ord. No. 2009-867.

**Action to be taken:**

violation must be corrected within 7 days

FAILURE TO CORRECT VIOLATION(S) WILL RESULT IN ISSUANCE OF A COURT SUMMONS TO APPEAR IN DISTRICT COURT. THE MAXIMUM FINE PER COURT SUMMONS IS \$100.00 EACH DAY IS A SEPARATE OFFENSE. THE CLEANUP BEING PERFORMED BY CITY OFFICIALS ON THE PROPERTY WILL RESULT IN PAYMENT AT THE OWNER(S) EXPENSE OF \$100.00 OR TEN PERCENT (10%) OF THE TOTAL COSTS INCURRED BY THE CITY TO REMEDY THE VIOLATION, WHICHEVER IS GREATER, AND AN ADDITION OF THE ACTUAL COST OF THE WORK INVOLVED IN CORRECTING THE CONDITIONS. A LIEN MAY BE FILED AGAINST THE PROPERTY AND AGAINST YOU AS THE OWNER FOR UNPAID FEES.

Thank You,

Office of Code Enforcement













## Notice of Violation

### City of Osceola

Office of Code Enforcement

303 West Hale Avenue P.O. Box 443

Osceola, AR 72370

Phone (870) 563-5245

Fax (870) 563-5195 or (870) 497-2228



02/14/2022

BLANCHARD, MARY C

P O BOX 221 OSCEOLA AR 72370

*Albert Boyd*

Subject Property: 110 WHEELER AR, , AR

Dear Property Owner:

YOU ARE HEREBY NOTIFIED TO DO THE FOLLOWING TO CORRECT THE VIOLATION(S) INDICATED BELOW:

**5.12.03 Weeds and Grass, Etc., Removal** - Weeds and grass, removal of rubbish, open storage, stagnant water. It shall be unlawful for any person owning and/or occupying any lot or real property within the City of Osceola, Arkansas, to allow weeds to grow thereon to a greater height of more than twelve (12) inches or to become unsightly or unsanitary, or to allow grass, garbage, rubbish, rotting or dead limbs or trees to become unsafe, unsightly and unsanitary or allow any icebox, refrigerator, stove, tires, building material, paper, building rubbish to be openly stored, or allow similar unsafe, unsightly and unsanitary. Ord. No. 2009-867.

**Action to be taken:**

Violations must be corrected within 7 days.

FAILURE TO CORRECT VIOLATION(S) WILL RESULT IN ISSUANCE OF A COURT SUMMONS TO APPEAR IN DISTRICT COURT. THE MAXIMUM FINE PER COURT SUMMONS IS \$100.00 EACH DAY IS A SEPARATE OFFENSE. THE CLEANUP BEING PERFORMED BY CITY OFFICIALS ON THE PROPERTY WILL RESULT IN PAYMENT AT THE OWNER(S) EXPENSE OF \$100.00 OR TEN PERCENT (10%) OF THE TOTAL COSTS INCURRED BY THE CITY TO REMEDY THE VIOLATION, WHICHEVER IS GREATER, AND AN ADDITION OF THE ACTUAL COST OF THE WORK INVOLVED IN CORRECTING THE CONDITIONS. A LIEN MAY BE FILED AGAINST THE PROPERTY AND AGAINST YOU AS THE OWNER FOR UNPAID FEES.

Thank You,

Office of Code Enforcement



110 Wheeler St  
Albert Boyd



## Notice of Violation

### City of Osceola

Office of Code Enforcement

303 West Hale Avenue P.O. Box 443

Osceola, AR 72370

Phone (870) 563-5245

Fax (870) 563-5195 or (870) 497-2228



02/14/2022

JOHNSON, COY & DELOIS J  
P O BOX 786 OSCEOLA AR 72370

Subject Property: 113 GREEN ACRES DR AR, , AR

Dear Property Owner:

YOU ARE HEREBY NOTIFIED TO DO THE FOLLOWING TO CORRECT THE VIOLATION(S) INDICATED BELOW:

**5.12.03 Weeds and Grass, Etc., Removal** - Weeds and grass, removal of rubbish, open storage, stagnant water. It shall be unlawful for any person owning and/or occupying any lot or real property within the City of Osceola, Arkansas, to allow weeds to grow thereon to a greater height of more than twelve (12) inches or to become unsightly or unsanitary, or to allow grass, garbage, rubbish, rotting or dead limbs or trees to become unsafe, unsightly and unsanitary or allow any icebox, refrigerator, stove, tires, building material, paper, building rubbish to be openly stored, or allow similar unsafe, unsightly and unsanitary. Ord. No. 2009-867.

**Action to be taken:**

Violation must be corrected within 30 days.

FAILURE TO CORRECT VIOLATION(S) WILL RESULT IN ISSUANCE OF A COURT SUMMONS TO APPEAR IN DISTRICT COURT. THE MAXIMUM FINE PER COURT SUMMONS IS \$100.00 EACH DAY IS A SEPARATE OFFENSE. THE CLEANUP BEING PERFORMED BY CITY OFFICIALS ON THE PROPERTY WILL RESULT IN PAYMENT AT THE OWNER(S) EXPENSE OF \$100.00 OR TEN PERCENT (10%) OF THE TOTAL COSTS INCURRED BY THE CITY TO REMEDY THE VIOLATION, WHICHEVER IS GREATER, AND AN ADDITION OF THE ACTUAL COST OF THE WORK INVOLVED IN CORRECTING THE CONDITIONS. A LIEN MAY BE FILED AGAINST THE PROPERTY AND AGAINST YOU AS THE OWNER FOR UNPAID FEES.

Thank You,

Office of Code Enforcement



113 Green Acres  
Unique Range



## Notice of Violation

### City of Osceola

Office of Code Enforcement

303 West Hale Avenue P.O. Box 443

Osceola, AR 72370

Phone (870) 563-5245

Fax (870) 563-5195 or (870) 497-2228



A Community United for Progress

02/14/2022

PULLIAM, ALFRED B & BESSIE M  
102 WHEELER OSCEOLA AR 72370

*Wiggly Reshm*

Subject Property: 102 WHEELER AR, , AR

Dear Property Owner:

YOU ARE HEREBY NOTIFIED TO DO THE FOLLOWING TO CORRECT THE VIOLATION(S) INDICATED BELOW:

**Property Maintenance** - 5.4.1 It shall be unlawful for the owner, owners or occupant of any lot or other real property within the City of Osceola, Arkansas to maintain or allow any dilapidated or unsightly building or structure on such lot or real property. Ord. No. 1991-650.

**Action to be taken:**

Violation must be corrected within 30 days.

FAILURE TO CORRECT VIOLATION(S) WILL RESULT IN ISSUANCE OF A COURT SUMMONS TO APPEAR IN DISTRICT COURT. THE MAXIMUM FINE PER COURT SUMMONS IS \$100.00 EACH DAY IS A SEPARATE OFFENSE. THE CLEANUP BEING PERFORMED BY CITY OFFICIALS ON THE PROPERTY WILL RESULT IN PAYMENT AT THE OWNER(S) EXPENSE OF \$100.00 OR TEN PERCENT (10%) OF THE TOTAL COSTS INCURRED BY THE CITY TO REMEDY THE VIOLATION, WHICHEVER IS GREATER, AND AN ADDITION OF THE ACTUAL COST OF THE WORK INVOLVED IN CORRECTING THE CONDITIONS. A LIEN MAY BE FILED AGAINST THE PROPERTY AND AGAINST YOU AS THE OWNER FOR UNPAID FEES.

Thank You,

Office of Code Enforcement



102 Wheeler St  
Inactive



# WIGGINS RESHUN

102 WHEELER  
OSCEOLA, AR 72358-2408

[Basic](#)[Sales](#)[Valuation](#)[Taxes](#)[Improvements](#)[Parcel Boundary 9](#)

## Basic Info

Parcel Number:	301-01179-000
County Name:	Mississippi County
Property Address:	WIGGINS RESHUN 102 WHEELER OSCEOLA, AR 72358-2408 <a href="#">Map This Address</a>
Mailing Address:	
Collector's Mailing Address :	WIGGINS RESHUN 102 WHEELER OSCEOLA, AR 72358
Total Acres:	0.21
Timber Acres:	0.00
Sec-Twp-Rng:	36-13-10
Lot/Block:	5/E
Subdivision:	
Legal Description:	LOT 5 BLOCK E GREEN ACRES ADD
School District:	1N OSCEOLA
Homestead Parcel?:	No
Tax Status:	Taxable
Over 65?:	No

## Notice of Violation

### City of Osceola

Office of Code Enforcement

303 West Hale Avenue P.O. Box 443

Osceola, AR 72370

Phone (870) 563-5245

Fax (870) 563-5195 or (870) 497-2228



A Community United for Progress

02/14/2022

MAHAN, PATRICIA

614 W KEISER OSCEOLA AR 72370

*Bret Parker*

Subject Property: 905 N GARDEN AR, , AR

Dear Property Owner:

YOU ARE HEREBY NOTIFIED TO DO THE FOLLOWING TO CORRECT THE VIOLATION(S) INDICATED BELOW:

**5.12.03 Weeds and Grass, Etc., Removal** - Weeds and grass, removal of rubbish, open storage, stagnant water. It shall be unlawful for any person owning and/or occupying any lot or real property within the City of Osceola, Arkansas, to allow weeds to grow thereon to a greater height of more than twelve (12) inches or to become unsightly or unsanitary, or to allow grass, garbage, rubbish, rotting or dead limbs or trees to become unsafe, unsightly and unsanitary or allow any icebox, refrigerator, stove, tires, building material, paper, building rubbish to be openly stored, or allow similar unsafe, unsightly and unsanitary. Ord. No. 2009-867.

**Action to be taken:**

Violation must be corrected with 7 days. Rubbish in carport and yard must be addressed.

FAILURE TO CORRECT VIOLATION(S) WILL RESULT IN ISSUANCE OF A COURT SUMMONS TO APPEAR IN DISTRICT COURT. THE MAXIMUM FINE PER COURT SUMMONS IS \$100.00 EACH DAY IS A SEPARATE OFFENSE. THE CLEANUP BEING PERFORMED BY CITY OFFICIALS ON THE PROPERTY WILL RESULT IN PAYMENT AT THE OWNER(S) EXPENSE OF \$100.00 OR TEN PERCENT (10%) OF THE TOTAL COSTS INCURRED BY THE CITY TO REMEDY THE VIOLATION, WHICHEVER IS GREATER, AND AN ADDITION OF THE ACTUAL COST OF THE WORK INVOLVED IN CORRECTING THE CONDITIONS. A LIEN MAY BE FILED AGAINST THE PROPERTY AND AGAINST YOU AS THE OWNER FOR UNPAID FEES.

Thank You,

Office of Code Enforcement





~~908 S Garden~~

908 N Garden Dr

Brnt Sparks

## Notice of Violation

### City of Osceola

Office of Code Enforcement

303 West Hale Avenue P.O. Box 443

Osceola, AR 72370

Phone (870) 563-5245

Fax (870) 563-5195 or (870) 497-2228



02/14/2022

ROBERTSON, WILLIAM L & DEBORAH  
315 W WASHINGTON OSCEOLA AR 72370

*Lemmie Meloria*

Subject Property: 604 N PEARL AR, , AR

Dear Property Owner:

YOU ARE HEREBY NOTIFIED TO DO THE FOLLOWING TO CORRECT THE VIOLATION(S) INDICATED BELOW:

**5.12.03 Weeds and Grass, Etc., Removal** - Weeds and grass, removal of rubbish, open storage, stagnant water. It shall be unlawful for any person owning and/or occupying any lot or real property within the City of Osceola, Arkansas, to allow weeds to grow thereon to a greater height of more than twelve (12) inches or to become unsightly or unsanitary, or to allow grass, garbage, rubbish, rotting or dead limbs or trees to become unsafe, unsightly and unsanitary or allow any icebox, refrigerator, stove, tires, building material, paper, building rubbish to be openly stored, or allow similar unsafe, unsightly and unsanitary. Ord. No. 2009-867.

**Action to be taken:**

Violations must be corrected within 7 days. Rubbish must be removed from exterior.

FAILURE TO CORRECT VIOLATION(S) WILL RESULT IN ISSUANCE OF A COURT SUMMONS TO APPEAR IN DISTRICT COURT. THE MAXIMUM FINE PER COURT SUMMONS IS \$100.00 EACH DAY IS A SEPARATE OFFENSE. THE CLEANUP BEING PERFORMED BY CITY OFFICIALS ON THE PROPERTY WILL RESULT IN PAYMENT AT THE OWNER(S) EXPENSE OF \$100.00 OR TEN PERCENT (10%) OF THE TOTAL COSTS INCURRED BY THE CITY TO REMEDY THE VIOLATION, WHICHEVER IS GREATER, AND AN ADDITION OF THE ACTUAL COST OF THE WORK INVOLVED IN CORRECTING THE CONDITIONS. A LIEN MAY BE FILED AGAINST THE PROPERTY AND AGAINST YOU AS THE OWNER FOR UNPAID FEES.

Thank You,

Office of Code Enforcement





604 N Pearl

Lemmie McLaurin

1/10/2022 1/10/2022

## Notice of Violation

### City of Osceola

Office of Code Enforcement

303 West Hale Avenue P.O. Box 443

Osceola, AR 72370

Phone (870) 563-5245

Fax (870) 563-5195 or (870) 497-2228



A Community United for Progress

---

02/14/2022

GREY, JAMIE L  
551 CHILDRESS OSCEOLA AR 72370

Subject Property: 551 CHILDRESS OSCEOLA AR, , AR

Dear Property Owner:

YOU ARE HEREBY NOTIFIED TO DO THE FOLLOWING TO CORRECT THE VIOLATION(S) INDICATED BELOW:

**Property Maintenance** - 5.4.1 It shall be unlawful for the owner, owners or occupant of any lot or other real property within the City of Osceola, Arkansas to maintain or allow any dilapidated or unsightly building or structure on such lot or real property. Ord. No. 1991-650.

**Action to be taken:**

Violations must be corrected within 30 days.

FAILURE TO CORRECT VIOLATION(S) WILL RESULT IN ISSUANCE OF A COURT SUMMONS TO APPEAR IN DISTRICT COURT. THE MAXIMUM FINE PER COURT SUMMONS IS \$100.00 EACH DAY IS A SEPARATE OFFENSE. THE CLEANUP BEING PERFORMED BY CITY OFFICIALS ON THE PROPERTY WILL RESULT IN PAYMENT AT THE OWNER(S) EXPENSE OF \$100.00 OR TEN PERCENT (10%) OF THE TOTAL COSTS INCURRED BY THE CITY TO REMEDY THE VIOLATION, WHICHEVER IS GREATER, AND AN ADDITION OF THE ACTUAL COST OF THE WORK INVOLVED IN CORRECTING THE CONDITIONS. A LIEN MAY BE FILED AGAINST THE PROPERTY AND AGAINST YOU AS THE OWNER FOR UNPAID FEES.

Thank You,

Office of Code Enforcement





551 Childress St  
I not in  
the system

# GREY JAMIE L

551 CHILDRESS  
OSCEOLA, AR 72370-1922



[Basic](#) [Sales](#) [Valuation](#) [Taxes](#) [Improvements](#) [Parcel Boundary](#)

## Basic Info

Parcel Number:	301-01103-000
County Name:	Mississippi County
Property Address:	GREY JAMIE L 551 CHILDRESS OSCEOLA, AR 72370-1922 <a href="#">Map This Address</a>
Mailing Address:	
Collector's Mailing Address :	GREY JAMIE LEE SR 551 CHILDRESS ST OSCEOLA, AR 72370
Total Acres:	0.24
Timber Acres:	0.00
Sec-Twp-Rng:	36-13-10
Lot/Block:	1/A
Subdivision:	
Legal Description:	LOT 1 BLOCK A GREEN ACRES ADD
School District:	1N OSCEOLA
Homestead Parcel?:	Yes
Tax Status:	Taxable
Over 65?:	No



## Notice of Violation

### City of Osceola

Office of Code Enforcement

303 West Hale Avenue P.O. Box 443

Osceola, AR 72370

Phone (870) 563-5245

Fax (870) 563-5195 or (870) 497-2228



02/14/2022

JACKSONVILLE FARMS INC  
P O BOX 188 OSCEOLA AR 72370

Subject Property: 0 N PEARL AR, , AR

Dear Property Owner:

YOU ARE HEREBY NOTIFIED TO DO THE FOLLOWING TO CORRECT THE VIOLATION(S) INDICATED BELOW:

**5.04.01 Property Maintenance** - It shall be unlawful for the owner, owners or occupant of any lot or other real property within the City of Osceola, Arkansas to maintain or allow any dilapidated or unsightly building or structure on such lot or real property. Ord. No. 1991-650.

**Action to be taken:**

Violations must be corrected within 30 days. Picture attached

FAILURE TO CORRECT VIOLATION(S) WILL RESULT IN ISSUANCE OF A COURT SUMMONS TO APPEAR IN DISTRICT COURT. THE MAXIMUM FINE PER COURT SUMMONS IS \$100.00 EACH DAY IS A SEPARATE OFFENSE. THE CLEANUP BEING PERFORMED BY CITY OFFICIALS ON THE PROPERTY WILL RESULT IN PAYMENT AT THE OWNER(S) EXPENSE OF \$100.00 OR TEN PERCENT (10%) OF THE TOTAL COSTS INCURRED BY THE CITY TO REMEDY THE VIOLATION, WHICHEVER IS GREATER, AND AN ADDITION OF THE ACTUAL COST OF THE WORK INVOLVED IN CORRECTING THE CONDITIONS. A LIEN MAY BE FILED AGAINST THE PROPERTY AND AGAINST YOU AS THE OWNER FOR UNPAID FEES.

Thank You,

Office of Code Enforcement



301-00105 - 0000  
Jacksonite Farm  
P.O. Box 188  
Osceola, AR 72370





# JACKSONVILLE FARMS INC

0 N PEARL  
OSCEOLA, AR 72370-0188



## Basic Information

Parcel Number: 301-00105-000

County Name: Mississippi County

Property Address: JACKSONVILLE FARMS INC  
0 N PEARL  
OSCEOLA, AR 72370-0188  
**Map This Address**

Mailing Address:

Collector's Mailing Address ⓘ: PAGE DONALD JAMES  
PO BOX 188  
OSCEOLA, AR 72370

Total Acres: 101.94

Timber Acres: 0.00

Sec-Twp-Rng: 25-13-10

Lot/Block: /

Subdivision:

Legal Description: E1870' SE1/4 (LESS H/W, R/R & STREET R/W) OF 25-13-10

School District: 1N OSCEOLA

Homestead Parcel?: No

Tax Status: Taxable

Over 65?: No

Parcel Boundary



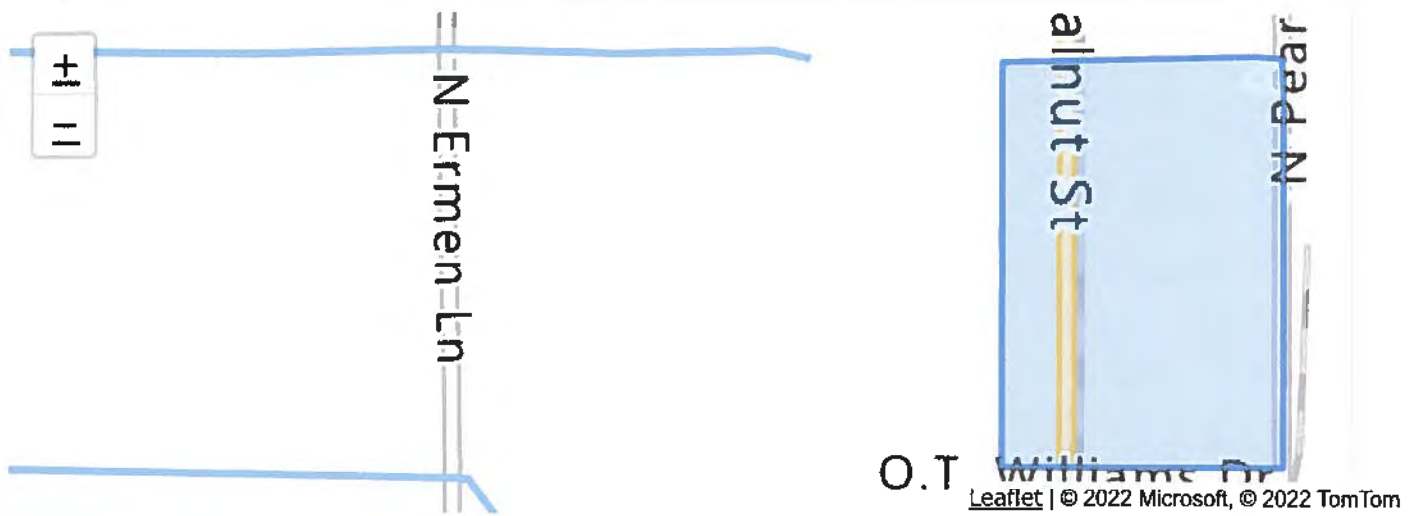

## Valuation Information

[view prior year information](#)

Entry	Appraised	Assessed
Land: ⓘ	108,425	21,685
Improvements: ⓘ	15,600	3,120
Total Value: ⓘ	124,025	24,805
Taxable Value: ⓘ		24,724
Millage:		0.0564
Estimated Taxes: ⓘ		\$1,394.43
Assessment Year:		2021

## Tax Information

Year	Book	Tax Owed	Tax Paid	Balance
<u>2020</u>	Current	\$1,436.51	-\$1,436.51	\$0.00

## Receipts

Receipt #	Book	Tax Year	ReceiptDate	Cash Amt	Check Amt	Credit Amt	Total
<u>9027</u>	Current	2020	9/10/2021	\$0.00	\$21,671.39	\$0.00	<b>\$21,671.39</b>

## Sales History ⓘ

Filed	Sold	Price	Grantor	Grantee	Book	Page	Deed Type
6/1/1981	6/1/1981	0	ESSO STANDARD OIL CO	JACKSONVILLE FARMS INC	165	71	
1/1/1959	1/1/1959	0	HUMBLE OIL & REF.	ESSO STANDARD OIL CO			
1/2/1951	1/2/1951	0		HUMBLE OIL & REF.			

## Improvement Information

## Residential Improvements

## Residential Improvement #1



Living Area 1st Floor	0	Basement Unfinished	0
Living Area 2nd Floor	0	Basement Finished w/Partitions	0
		Basement Finished w/o Partitions	0
<b>Living Area Total SF</b>	<b>0</b>	<b>Basement Total SF</b>	<b>0</b>

Occupancy Type:

Grade: D

Story Height:

Year Built: Year Built Not Available

Effective Age:

Construction Type:

Roof Type: Unkown

Heat / AC: None

Fireplace: 0

Bathrooms:

Foundation Type: Unkown

Floor Type: Unkown

Floor Covering:

## Residential Improvement #2



# No Image Available

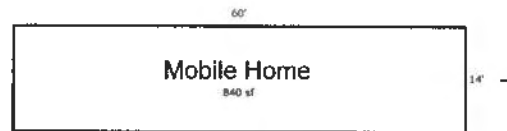

Living Area 1st Floor

0 Basement Unfinished

0

Living Area 2nd Floor

0 Basement Finished w/Partitions

0

Basement Finished w/o Partitions

0

**Living Area Total SF****0 Basement Total SF****0**

Occupancy Type:

Grade:

D

Story Height:

Year Built:

Year Built Not Available

Effective Age:

Construction Type:

Roof Type:

Unkown

Heat / AC:

None

Fireplace:

0

Bathrooms:

Foundation Type:

Unkown

Floor Type:

Unkown

Floor Covering:

## Notice of Violation

### City of Osceola

Office of Code Enforcement

303 West Hale Avenue P.O. Box 443

Osceola, AR 72370

Phone (870) 563-5245

Fax (870) 563-5195 or (870) 497-2228



02/14/2022

GILES, LEROY

406 W LEE OSCEOLA AR 72370

Subject Property: 406 W BARD AR, , AR

Dear Property Owner:

YOU ARE HEREBY NOTIFIED TO DO THE FOLLOWING TO CORRECT THE VIOLATION(S) INDICATED BELOW:

**5.12.01 Construction Waste** - 1. From and after approval of the passage of this Ordinance it shall be unlawful for any contractor, sub-contractor, or private property owner to place any waste material from any construction, roofing, painting, siding or other such improvement project on public or private property to be disposed of by the City. Ord. No. 1991-637.

2. All contractors, sub-contractors and private property owners shall be responsible for the removal and disposal of all waste materials resulting from construction or improvement projects in accordance with applicable laws and regulations and this Ordinance. Ord. No. 1991-637.

3. Any person or firm who violates the provisions of this Ordinance shall be deemed guilty of a misdemeanor and upon conviction shall be fined in a sum not less than \$25.00 nor more than \$100.00 or confined in the city jail for not more than thirty (30) days, or both, such fine and confinement, and each violation of this Ordinance shall be considered a separate offense. Ord. No. 1991-637.

#### Action to be taken:

Violations must be corrected within 30 days.

FAILURE TO CORRECT VIOLATION(S) WILL RESULT IN ISSUANCE OF A COURT SUMMONS TO APPEAR IN DISTRICT COURT. THE MAXIMUM FINE PER COURT SUMMONS IS \$100.00 EACH DAY IS A SEPARATE OFFENSE. THE CLEANUP BEING PERFORMED BY CITY OFFICIALS ON THE PROPERTY WILL RESULT IN PAYMENT AT THE OWNER(S) EXPENSE OF \$100.00 OR TEN PERCENT (10%) OF THE TOTAL COSTS INCURRED BY THE CITY TO REMEDY THE VIOLATION, WHICHEVER IS GREATER, AND AN ADDITION OF THE ACTUAL COST OF THE WORK INVOLVED IN CORRECTING THE CONDITIONS. A LIEN MAY BE FILED AGAINST THE PROPERTY AND AGAINST YOU AS THE OWNER FOR UNPAID FEES.

Thank You,

Office of Code Enforcement





406 W Bad Ave  
Deborah Scott Temp

## Notice of Violation

### City of Osceola

Office of Code Enforcement

303 West Hale Avenue P.O. Box 443

Osceola, AR 72370

Phone (870) 563-5245

Fax (870) 563-5195 or (870) 497-2228



02/14/2022

JONES, JANET

1174 WEST MESQUITE AVE APACHE JUNCTION AZ 85120

*Sanh Frazier*

Subject Property: 319 N MAPLE OSCEOLA AR, , AR

Dear Property Owner:

YOU ARE HEREBY NOTIFIED TO DO THE FOLLOWING TO CORRECT THE VIOLATION(S) INDICATED BELOW:

**5.04.01 Property Maintenance** - It shall be unlawful for the owner, owners or occupant of any lot or other real property within the City of Osceola, Arkansas to maintain or allow any dilapidated or unsightly building or structure on such lot or real property. Ord. No. 1991-650.

**Action to be taken:**

Violations must be corrected within 30 days.

FAILURE TO CORRECT VIOLATION(S) WILL RESULT IN ISSUANCE OF A COURT SUMMONS TO APPEAR IN DISTRICT COURT. THE MAXIMUM FINE PER COURT SUMMONS IS \$100.00 EACH DAY IS A SEPARATE OFFENSE. THE CLEANUP BEING PERFORMED BY CITY OFFICIALS ON THE PROPERTY WILL RESULT IN PAYMENT AT THE OWNER(S) EXPENSE OF \$100.00 OR TEN PERCENT (10%) OF THE TOTAL COSTS INCURRED BY THE CITY TO REMEDY THE VIOLATION, WHICHEVER IS GREATER, AND AN ADDITION OF THE ACTUAL COST OF THE WORK INVOLVED IN CORRECTING THE CONDITIONS. A LIEN MAY BE FILED AGAINST THE PROPERTY AND AGAINST YOU AS THE OWNER FOR UNPAID FEES.

Thank You,

Office of Code Enforcement





319 N Maple St  
Sarah Traylor

## Notice of Violation

### City of Osceola

Office of Code Enforcement

303 West Hale Avenue P.O. Box 443

Osceola, AR 72370

Phone (870) 563-5245

Fax (870) 563-5195 or (870) 497-2228



02/14/2022

**BINGHAM, MICHAEL T**

411 W JOHNSON OSCEOLA AR 72370

Antelope, CA 958435437

Subject Property: 411 W JOHNSON OSCEOLA AR, Osceola, AR

Dear Property Owner:

YOU ARE HEREBY NOTIFIED TO DO THE FOLLOWING TO CORRECT THE VIOLATION(S) INDICATED BELOW:

**Property Maintenance** - 5.4.1 It shall be unlawful for the owner, owners or occupant of any lot or other real property within the City of Osceola, Arkansas to maintain or allow any dilapidated or unsightly building or structure on such lot or real property. Ord. No. 1991-650.

**Action to be taken:**

Violations must be corrected within 30 days.

FAILURE TO CORRECT VIOLATION(S) WILL RESULT IN ISSUANCE OF A COURT SUMMONS TO APPEAR IN DISTRICT COURT. THE MAXIMUM FINE PER COURT SUMMONS IS \$100.00 EACH DAY IS A SEPARATE OFFENSE. THE CLEANUP BEING PERFORMED BY CITY OFFICIALS ON THE PROPERTY WILL RESULT IN PAYMENT AT THE OWNER(S) EXPENSE OF \$100.00 OR TEN PERCENT (10%) OF THE TOTAL COSTS INCURRED BY THE CITY TO REMEDY THE VIOLATION, WHICHEVER IS GREATER, AND AN ADDITION OF THE ACTUAL COST OF THE WORK INVOLVED IN CORRECTING THE CONDITIONS. A LIEN MAY BE FILED AGAINST THE PROPERTY AND AGAINST YOU AS THE OWNER FOR UNPAID FEES.

Thank You,

Office of Code Enforcement





411 W Johnson Ave  
Inactive

# VELVET CLOVER LLC

411 W JOHNSON  
OSCEOLA, AR  
▼

[Basic](#)[Sales](#)[Valuation](#)[Taxes](#)[Improvements](#)[Parcel Boundary](#) 9

## Basic Info

Parcel Number:	301-02708-000
County Name:	Mississippi County
Property Address:	VELVET CLOVER LLC 411 W JOHNSON OSCEOLA, AR <a href="#">Map This Address</a>
Mailing Address:	
Collector's Mailing Address :	VELVET CLOVER LLC 3753 ELK RIVER CT ANTELOPE, CA 95743
Total Acres:	0.13
Timber Acres:	0.00
Sec-Twp-Rng:	36-13-10
Lot/Block:	3/9
Subdivision:	
Legal Description:	LT 3 BLK 9 TOWNSITE ADD 411 W JOHNSON
School District:	1N OSCEOLA
Homestead Parcel?:	No
Tax Status:	Taxable
Over 65?:	No





## Notice of Violation

### City of Osceola

Office of Code Enforcement

303 West Hale Avenue P.O. Box 443

Osceola, AR 72370

Phone (870) 563-5245

Fax (870) 563-5195 or (870) 497-2228



02/14/2022

ROBERTSON, WILLIAM L & DEBORAH  
315 W WASHINGTON OSCEOLA AR 72370

Subject Property: 400 W FORD OSCEOLA AR, , AR

Dear Property Owner:

YOU ARE HEREBY NOTIFIED TO DO THE FOLLOWING TO CORRECT THE VIOLATION(S) INDICATED BELOW:

**5.04.01 Property Maintenance** - It shall be unlawful for the owner, owners or occupant of any lot or other real property within the City of Osceola, Arkansas to maintain or allow any dilapidated or unsightly building or structure on such lot or real property. Ord. No. 1991-650.

**Action to be taken:**

Violations must be corrected within 30 days. Pictures are attached of structures that are of concern.

FAILURE TO CORRECT VIOLATION(S) WILL RESULT IN ISSUANCE OF A COURT SUMMONS TO APPEAR IN DISTRICT COURT. THE MAXIMUM FINE PER COURT SUMMONS IS \$100.00 EACH DAY IS A SEPARATE OFFENSE. THE CLEANUP BEING PERFORMED BY CITY OFFICIALS ON THE PROPERTY WILL RESULT IN PAYMENT AT THE OWNER(S) EXPENSE OF \$100.00 OR TEN PERCENT (10%) OF THE TOTAL COSTS INCURRED BY THE CITY TO REMEDY THE VIOLATION, WHICHEVER IS GREATER, AND AN ADDITION OF THE ACTUAL COST OF THE WORK INVOLVED IN CORRECTING THE CONDITIONS. A LIEN MAY BE FILED AGAINST THE PROPERTY AND AGAINST YOU AS THE OWNER FOR UNPAID FEES.

Thank You,

Office of Code Enforcement





402 W Ford Ave  
Inactive

# ROBERTSON WILLIAM L & DEBORAH

400 W FORD  
OSCEOLA, AR 72370-2524



[Basic](#) [Sales](#) [Valuation](#) [Taxes](#) [Receipts](#) [Improvements](#) [Parcel Boundary](#)

## Basic Info

Parcel Number: 301-02806-000

County Name: Mississippi County

Property Address: ROBERTSON WILLIAM L & DEBORAH  
400 W FORD  
OSCEOLA, AR 72370-2524  
[Map This Address](#)

Mailing Address:

Collector's Mailing Address : ROBERTSON WILLIAM L & DEBORAH  
117 W ALICIA ST  
OSCEOLA, AR 72370

Total Acres: 0.44

Timber Acres: 0.00

Sec-Twp-Rng: 36-13-10

Lot/Block: 12-1/21

Subdivision:

Legal Description: LTS 12, 13 & 14 BLK 21 & S10' TOWNSITE ADD 400 W FORD ALLEY N OF LOTS 12, 13 & 14 OF 36-13-10

School District: 1N OSCEOLA

Homestead Parcel?: No

Tax Status: Taxable

Over 65?: No



AR  
COUNTY  
DATA

## Notice of Violation

### City of Osceola

Office of Code Enforcement

303 West Hale Avenue P.O. Box 443

Osceola, AR 72370

Phone (870) 563-5245

Fax (870) 563-5195 or (870) 497-2228



02/14/2022

BROWN, HELEN  
407 W FORD OSCEOLA AR 72370

Subject Property: 407 W FORD AR, , AR

Dear Property Owner:

YOU ARE HEREBY NOTIFIED TO DO THE FOLLOWING TO CORRECT THE VIOLATION(S) INDICATED BELOW:

**5.04.01 Property Maintenance** - It shall be unlawful for the owner, owners or occupant of any lot or other real property within the City of Osceola, Arkansas to maintain or allow any dilapidated or unsightly building or structure on such lot or real property. Ord. No. 1991-650.

**Action to be taken:**

Violations must be corrected within 30days.

FAILURE TO CORRECT VIOLATION(S) WILL RESULT IN ISSUANCE OF A COURT SUMMONS TO APPEAR IN DISTRICT COURT. THE MAXIMUM FINE PER COURT SUMMONS IS \$100.00 EACH DAY IS A SEPARATE OFFENSE. THE CLEANUP BEING PERFORMED BY CITY OFFICIALS ON THE PROPERTY WILL RESULT IN PAYMENT AT THE OWNER(S) EXPENSE OF \$100.00 OR TEN PERCENT (10%) OF THE TOTAL COSTS INCURRED BY THE CITY TO REMEDY THE VIOLATION, WHICHEVER IS GREATER, AND AN ADDITION OF THE ACTUAL COST OF THE WORK INVOLVED IN CORRECTING THE CONDITIONS. A LIEN MAY BE FILED AGAINST THE PROPERTY AND AGAINST YOU AS THE OWNER FOR UNPAID FEES.

Thank You,

Office of Code Enforcement





407 W Ford Ave  
Inactive

## Notice of Violation

### City of Osceola

Office of Code Enforcement

303 West Hale Avenue P.O. Box 443

Osceola, AR 72370

Phone (870) 563-5245

Fax (870) 563-5195 or (870) 497-2228



02/14/2022

B & A WRIGHT PROPERTIES, INC  
810 BETTY LYNN OSCEOLA AR 72370

Subject Property: 413 W FORD AR, , AR

Dear Property Owner:

YOU ARE HEREBY NOTIFIED TO DO THE FOLLOWING TO CORRECT THE VIOLATION(S) INDICATED BELOW:

**5.04.01 Property Maintenance** - It shall be unlawful for the owner, owners or occupant of any lot or other real property within the City of Osceola, Arkansas to maintain or allow any dilapidated or unsightly building or structure on such lot or real property. Ord. No. 1991-650.

**Action to be taken:**

Violations must be corrected within 30days. property has boarded up windows. Windows that are broken, and loose siding.

FAILURE TO CORRECT VIOLATION(S) WILL RESULT IN ISSUANCE OF A COURT SUMMONS TO APPEAR IN DISTRICT COURT. THE MAXIMUM FINE PER COURT SUMMONS IS \$100.00 EACH DAY IS A SEPARATE OFFENSE. THE CLEANUP BEING PERFORMED BY CITY OFFICIALS ON THE PROPERTY WILL RESULT IN PAYMENT AT THE OWNER(S) EXPENSE OF \$100.00 OR TEN PERCENT (10%) OF THE TOTAL COSTS INCURRED BY THE CITY TO REMEDY THE VIOLATION, WHICHEVER IS GREATER, AND AN ADDITION OF THE ACTUAL COST OF THE WORK INVOLVED IN CORRECTING THE CONDITIONS. A LIEN MAY BE FILED AGAINST THE PROPERTY AND AGAINST YOU AS THE OWNER FOR UNPAID FEES.

Thank You,

Office of Code Enforcement





413 W Ford Ave  
Buddy Wright Temp

# B & A WRIGHT PROPERTIES INC

413 415 W FORD  
OSCEOLA, AR 72370-1709

[Basic](#)[Sales](#)[Valuation](#)[Taxes](#)[Receipts](#)[Improvements](#)[Parcel Boundary](#)

## Basic Info

Parcel Number: 301-02812-000

County Name: Mississippi County

Property Address: B & A WRIGHT PROPERTIES INC  
413 415 W FORD  
OSCEOLA, AR 72370-1709  
[Map This Address](#)

Mailing Address:

Collector's Mailing Address : WRIGHT BUDDY R  
107 GARY LYNN DR  
OSCEOLA, AR 72370

Total Acres: 0.06

Timber Acres: 0.00

Sec-Twp-Rng: 36-13-10

Lot/Block: 4/22

Subdivision:

Legal Description: N1/2 LT 4 BLK 22 TOWNSITE ADD 413-415 W FORD

School District: 1N OSCEOLA

Homestead Parcel?: No

Tax Status: Taxable

Over 65?: No





## Notice of Violation

### City of Osceola

Office of Code Enforcement

303 West Hale Avenue P.O. Box 443

Osceola, AR 72370

Phone (870) 563-5245

Fax (870) 563-5195 or (870) 497-2228



02/14/2022

GILES, LEROY  
406 W LEE OSCEOLA AR 72370

Subject Property: 406 W LEE AR, , AR

Dear Property Owner:

YOU ARE HEREBY NOTIFIED TO DO THE FOLLOWING TO CORRECT THE VIOLATION(S) INDICATED BELOW:

**5.08.01 Inoperable Vehicles** - It shall be unlawful for the owner, owners, or occupant of any lot or other real property within the City of Osceola, Arkansas to utilize the premises for Commercial and/or open storage of any inoperable motor vehicle. An inoperable motor vehicle for the purpose of this Ordinance, is defined as one that is in a state of disrepair and incapable of being moved under it's own power or one that does not have current, valid license plates. Ord. No. 1993-679.

**Action to be taken:**

Violations must be corrected within 7 days.

FAILURE TO CORRECT VIOLATION(S) WILL RESULT IN ISSUANCE OF A COURT SUMMONS TO APPEAR IN DISTRICT COURT. THE MAXIMUM FINE PER COURT SUMMONS IS \$100.00 EACH DAY IS A SEPARATE OFFENSE. THE CLEANUP BEING PERFORMED BY CITY OFFICIALS ON THE PROPERTY WILL RESULT IN PAYMENT AT THE OWNER(S) EXPENSE OF \$100.00 OR TEN PERCENT (10%) OF THE TOTAL COSTS INCURRED BY THE CITY TO REMEDY THE VIOLATION, WHICHEVER IS GREATER, AND AN ADDITION OF THE ACTUAL COST OF THE WORK INVOLVED IN CORRECTING THE CONDITIONS. A LIEN MAY BE FILED AGAINST THE PROPERTY AND AGAINST YOU AS THE OWNER FOR UNPAID FEES.

Thank You,

Office of Code Enforcement





406 W Lee Ave  
Inactive







## Notice of Violation

### City of Osceola

Office of Code Enforcement

303 West Hale Avenue P.O. Box 443

Osceola, AR 72370

Phone (870) 563-5245

Fax (870) 563-5195 or (870) 497-2228



A Community United for Progress

02/14/2022

WELCH, DONALD & TAMMY  
612 W QUINN OSCEOLA AR 72370

Subject Property: 612 W QUINN OSCEOLA AR, , AR

Dear Property Owner:

YOU ARE HEREBY NOTIFIED TO DO THE FOLLOWING TO CORRECT THE VIOLATION(S) INDICATED BELOW:

**5.12.03 Weeds and Grass, Etc., Removal** - Weeds and grass, removal of rubbish, open storage, stagnant water. It shall be unlawful for any person owning and/or occupying any lot or real property within the City of Osceola, Arkansas, to allow weeds to grow thereon to a greater height of more than twelve (12) inches or to become unsightly or unsanitary, or to allow grass, garbage, rubbish, rotting or dead limbs or trees to become unsafe, unsightly and unsanitary or allow any icebox, refrigerator, stove, tires, building material, paper, building rubbish to be openly stored, or allow similar unsafe, unsightly and unsanitary. Ord. No. 2009-867.

**Action to be taken:**

Appliance near carport must be removed within 7 days.

FAILURE TO CORRECT VIOLATION(S) WILL RESULT IN ISSUANCE OF A COURT SUMMONS TO APPEAR IN DISTRICT COURT. THE MAXIMUM FINE PER COURT SUMMONS IS \$100.00 EACH DAY IS A SEPARATE OFFENSE. THE CLEANUP BEING PERFORMED BY CITY OFFICIALS ON THE PROPERTY WILL RESULT IN PAYMENT AT THE OWNER(S) EXPENSE OF \$100.00 OR TEN PERCENT (10%) OF THE TOTAL COSTS INCURRED BY THE CITY TO REMEDY THE VIOLATION, WHICHEVER IS GREATER, AND AN ADDITION OF THE ACTUAL COST OF THE WORK INVOLVED IN CORRECTING THE CONDITIONS. A LIEN MAY BE FILED AGAINST THE PROPERTY AND AGAINST YOU AS THE OWNER FOR UNPAID FEES.

Thank You,

Office of Code Enforcement



612 W Quinn Ave  
Donald Welch



## Notice of Violation

### City of Osceola

Office of Code Enforcement

303 West Hale Avenue P.O. Box 443

Osceola, AR 72370

Phone (870) 563-5245

Fax (870) 563-5195 or (870) 497-2228



02/14/2022

LETT, TISHER & AUGUSTUS W  
853 W 129TH PLACE CHICAGO IL 60643

*Tiffany County*

Subject Property: 309 LINWOOD AR, , AR

Dear Property Owner:

YOU ARE HEREBY NOTIFIED TO DO THE FOLLOWING TO CORRECT THE VIOLATION(S) INDICATED BELOW:

**5.12.03 Weeds and Grass, Etc., Removal** - Weeds and grass, removal of rubbish, open storage, stagnant water. It shall be unlawful for any person owning and/or occupying any lot or real property within the City of Osceola, Arkansas, to allow weeds to grow thereon to a greater height of more than twelve (12) inches or to become unsightly or unsanitary, or to allow grass, garbage, rubbish, rotting or dead limbs or trees to become unsafe, unsightly and unsanitary or allow any icebox, refrigerator, stove, tires, building material, paper, building rubbish to be openly stored, or allow similar unsafe, unsightly and unsanitary. Ord. No. 2009-867.

**Action to be taken:**

Violation must be corrected within 7 days. Rubbish including tires near hedges must be removed.

FAILURE TO CORRECT VIOLATION(S) WILL RESULT IN ISSUANCE OF A COURT SUMMONS TO APPEAR IN DISTRICT COURT. THE MAXIMUM FINE PER COURT SUMMONS IS \$100.00 EACH DAY IS A SEPARATE OFFENSE. THE CLEANUP BEING PERFORMED BY CITY OFFICIALS ON THE PROPERTY WILL RESULT IN PAYMENT AT THE OWNER(S) EXPENSE OF \$100.00 OR TEN PERCENT (10%) OF THE TOTAL COSTS INCURRED BY THE CITY TO REMEDY THE VIOLATION, WHICHEVER IS GREATER, AND AN ADDITION OF THE ACTUAL COST OF THE WORK INVOLVED IN CORRECTING THE CONDITIONS. A LIEN MAY BE FILED AGAINST THE PROPERTY AND AGAINST YOU AS THE OWNER FOR UNPAID FEES.

Thank You,

Office of Code Enforcement



309 Linval St  
diffang cowly



## Notice of Violation

### City of Osceola

Office of Code Enforcement

303 West Hale Avenue P.O. Box 443

Osceola, AR 72370

Phone (870) 563-5245

Fax (870) 563-5195 or (870) 497-2228



02/14/2022

DILLARD, SADIE CLEO & CHARLES  
121 EAST DR OSCEOLA AR 72370

Subject Property: 2008 N PEARL AR, , AR

Dear Property Owner:

YOU ARE HEREBY NOTIFIED TO DO THE FOLLOWING TO CORRECT THE VIOLATION(S) INDICATED BELOW:

**5.12.03 Weeds and Grass, Etc., Removal** - Weeds and grass, removal of rubbish, open storage, stagnant water. It shall be unlawful for any person owning and/or occupying any lot or real property within the City of Osceola, Arkansas, to allow weeds to grow thereon to a greater height of more than twelve (12) inches or to become unsightly or unsanitary, or to allow grass, garbage, rubbish, rotting or dead limbs or trees to become unsafe, unsightly and unsanitary or allow any icebox, refrigerator, stove, tires, building material, paper, building rubbish to be openly stored, or allow similar unsafe, unsightly and unsanitary. Ord. No. 2009-867.

**Property Maintenance** - 5.4.1 It shall be unlawful for the owner, owners or occupant of any lot or other real property within the City of Osceola, Arkansas to maintain or allow any dilapidated or unsightly building or structure on such lot or real property. Ord. No. 1991-650.

**Action to be taken:**

Violations must be corrected within 14 days.

FAILURE TO CORRECT VIOLATION(S) WILL RESULT IN ISSUANCE OF A COURT SUMMONS TO APPEAR IN DISTRICT COURT. THE MAXIMUM FINE PER COURT SUMMONS IS \$100.00 EACH DAY IS A SEPARATE OFFENSE. THE CLEANUP BEING PERFORMED BY CITY OFFICIALS ON THE PROPERTY WILL RESULT IN PAYMENT AT THE OWNER(S) EXPENSE OF \$100.00 OR TEN PERCENT (10%) OF THE TOTAL COSTS INCURRED BY THE CITY TO REMEDY THE VIOLATION, WHICHEVER IS GREATER, AND AN ADDITION OF THE ACTUAL COST OF THE WORK INVOLVED IN CORRECTING THE CONDITIONS. A LIEN MAY BE FILED AGAINST THE PROPERTY AND AGAINST YOU AS THE OWNER FOR UNPAID FEES.

Thank You,

Office of Code Enforcement



2008 N Pearl  
Inactive



## Notice of Violation

### City of Osceola

Office of Code Enforcement

303 West Hale Avenue P.O. Box 443

Osceola, AR 72370

Phone (870) 563-5245

Fax (870) 563-5195 or (870) 497-2228



02/14/2022

WILSON, LARRY  
2707 CROOKED STICK RD BENTON AR 72019

Subject Property: 2002 N PEARL AR, , AR

Dear Property Owner:

YOU ARE HEREBY NOTIFIED TO DO THE FOLLOWING TO CORRECT THE VIOLATION(S) INDICATED BELOW:

**Property Maintenance** - 5.4.1 It shall be unlawful for the owner, owners or occupant of any lot or other real property within the City of Osceola, Arkansas to maintain or allow any dilapidated or unsightly building or structure on such lot or real property. Ord. No. 1991-650.

**Action to be taken:**

Plan of action must be submitted to our office within 14 days detailing plan for burnt structure.

FAILURE TO CORRECT VIOLATION(S) WILL RESULT IN ISSUANCE OF A COURT SUMMONS TO APPEAR IN DISTRICT COURT. THE MAXIMUM FINE PER COURT SUMMONS IS \$100.00 EACH DAY IS A SEPARATE OFFENSE. THE CLEANUP BEING PERFORMED BY CITY OFFICIALS ON THE PROPERTY WILL RESULT IN PAYMENT AT THE OWNER(S) EXPENSE OF \$100.00 OR TEN PERCENT (10%) OF THE TOTAL COSTS INCURRED BY THE CITY TO REMEDY THE VIOLATION, WHICHEVER IS GREATER, AND AN ADDITION OF THE ACTUAL COST OF THE WORK INVOLVED IN CORRECTING THE CONDITIONS. A LIEN MAY BE FILED AGAINST THE PROPERTY AND AGAINST YOU AS THE OWNER FOR UNPAID FEES.

Thank You,

Office of Code Enforcement



2002 N Pearl  
Angela Marsh



## Notice of Violation

### City of Osceola

Office of Code Enforcement

303 West Hale Avenue P.O. Box 443

Osceola, AR 72370

Phone (870) 563-5245

Fax (870) 563-5195 or (870) 497-2228



02/14/2022

LATHAM, LAFONCE G II  
8000 N PEARL OSCEOLA AR 72370

Subject Property: 8000 N PEARL AR, , AR

Dear Property Owner:

YOU ARE HEREBY NOTIFIED TO DO THE FOLLOWING TO CORRECT THE VIOLATION(S) INDICATED BELOW:

**5.08.02 Inoperable Vehicles Removal** - Any inoperable vehicle located on a vacant lot or unoccupied real property within the City of Osceola shall, after and attempt to locate the owner, shall be ordered removed by the Chief of Police and disposed of by the means provided by law. Ord. No. 1993-679.

**5.12.03 Weeds and Grass, Etc., Removal** - Weeds and grass, removal of rubbish, open storage, stagnant water. It shall be unlawful for any person owning and/or occupying any lot or real property within the City of Osceola, Arkansas, to allow weeds to grow thereon to a greater height of more than twelve (12) inches or to become unsightly or unsanitary, or to allow grass, garbage, rubbish, rotting or dead limbs or trees to become unsafe, unsightly and unsanitary or allow any icebox, refrigerator, stove, tires, building material, paper, building rubbish to be openly stored, or allow similar unsafe, unsightly and unsanitary. Ord. No. 2009-867.

**Action to be taken:**

Violations must be corrected within 14 days.

FAILURE TO CORRECT VIOLATION(S) WILL RESULT IN ISSUANCE OF A COURT SUMMONS TO APPEAR IN DISTRICT COURT. THE MAXIMUM FINE PER COURT SUMMONS IS \$100.00 EACH DAY IS A SEPARATE OFFENSE. THE CLEANUP BEING PERFORMED BY CITY OFFICIALS ON THE PROPERTY WILL RESULT IN PAYMENT AT THE OWNER(S) EXPENSE OF \$100.00 OR TEN PERCENT (10%) OF THE TOTAL COSTS INCURRED BY THE CITY TO REMEDY THE VIOLATION, WHICHEVER IS GREATER, AND AN ADDITION OF THE ACTUAL COST OF THE WORK INVOLVED IN CORRECTING THE CONDITIONS. A LIEN MAY BE FILED AGAINST THE PROPERTY AND AGAINST YOU AS THE OWNER FOR UNPAID FEES.

Thank You,

Office of Code Enforcement





. 7000 N. Pearl  
Lafayette Latham Jr.



## Notice of Violation

### City of Osceola

Office of Code Enforcement

303 West Hale Avenue P.O. Box 443

Osceola, AR 72370

Phone (870) 563-5245

Fax (870) 563-5195 or (870) 497-2228



02/14/2022

GRIMES, JESSIE  
P O BOX 859 OSCEOLA AR 72370

Subject Property: 5008 N PEARL AR, , AR

Dear Property Owner:

YOU ARE HEREBY NOTIFIED TO DO THE FOLLOWING TO CORRECT THE VIOLATION(S) INDICATED BELOW:

**5.04.01 Property Maintenance** - It shall be unlawful for the owner, owners or occupant of any lot or other real property within the City of Osceola, Arkansas to maintain or allow any dilapidated or unsightly building or structure on such lot or real property. Ord. No. 1991-650.

**5.08.01 Inoperable Vehicles** - It shall be unlawful for the owner, owners, or occupant of any lot or other real property within the City of Osceola, Arkansas to utilize the premises for Commercial and/or open storage of any inoperable motor vehicle. An inoperable motor vehicle for the purpose of this Ordinance, is defined as one that is in a state of disrepair and incapable of being moved under it's own power or one that does not have current, valid license plates. Ord. No. 1993-679.

**5.12.03 Weeds and Grass, Etc., Removal** - Weeds and grass, removal of rubbish, open storage, stagnant water. It shall be unlawful for any person owning and/or occupying any lot or real property within the City of Osceola, Arkansas, to allow weeds to grow thereon to a greater height of more than twelve (12) inches or to become unsightly or unsanitary, or to allow grass, garbage, rubbish, rotting or dead limbs or trees to become unsafe, unsightly and unsanitary or allow any icebox, refrigerator, stove, tires, building material, paper, building rubbish to be openly stored, or allow similar unsafe, unsightly and unsanitary. Ord. No. 2009-867.

**Action to be taken:**

Violations must be corrected within 30 days.

FAILURE TO CORRECT VIOLATION(S) WILL RESULT IN ISSUANCE OF A COURT SUMMONS TO APPEAR IN DISTRICT COURT. THE MAXIMUM FINE PER COURT SUMMONS IS \$100.00 EACH DAY IS A SEPARATE OFFENSE. THE CLEANUP BEING PERFORMED BY CITY OFFICIALS ON THE PROPERTY WILL RESULT IN PAYMENT AT THE OWNER(S) EXPENSE OF \$100.00 OR TEN PERCENT (10%) OF THE TOTAL COSTS INCURRED BY THE CITY TO REMEDY THE VIOLATION, WHICHEVER IS GREATER, AND AN ADDITION OF THE ACTUAL COST OF THE WORK INVOLVED IN CORRECTING THE CONDITIONS. A LIEN MAY BE FILED AGAINST THE PROPERTY AND AGAINST YOU AS THE OWNER FOR UNPAID FEES.

Thank You,

Office of Code Enforcement



608 N Pearl  
Stacy Rasker



## Notice of Violation

### City of Osceola

Office of Code Enforcement

303 West Hale Avenue P.O. Box 443

Osceola, AR 72370

Phone (870) 563-5245

Fax (870) 563-5195 or (870) 497-2228



A Community United for Progress

02/14/2022

BARCH, JOHN

601 S ERMAN OSCEOLA AR 72370

Subject Property: 6000 N PEARL OSCEOLA AR, , AR

Dear Property Owner:

YOU ARE HEREBY NOTIFIED TO DO THE FOLLOWING TO CORRECT THE VIOLATION(S) INDICATED BELOW:

**5.12.03 Weeds and Grass, Etc., Removal** - Weeds and grass, removal of rubbish, open storage, stagnant water. It shall be unlawful for any person owning and/or occupying any lot or real property within the City of Osceola, Arkansas, to allow weeds to grow thereon to a greater height of more than twelve (12) inches or to become unsightly or unsanitary, or to allow grass, garbage, rubbish, rotting or dead limbs or trees to become unsafe, unsightly and unsanitary or allow any icebox, refrigerator, stove, tires, building material, paper, building rubbish to be openly stored, or allow similar unsafe, unsightly and unsanitary. Ord. No. 2009-867.

**Property Maintenance** - 5.4.1 It shall be unlawful for the owner, owners or occupant of any lot or other real property within the City of Osceola, Arkansas to maintain or allow any dilapidated or unsightly building or structure on such lot or real property. Ord. No. 1991-650.

**Action to be taken:**

Violations must be corrected within 30 days.

FAILURE TO CORRECT VIOLATION(S) WILL RESULT IN ISSUANCE OF A COURT SUMMONS TO APPEAR IN DISTRICT COURT. THE MAXIMUM FINE PER COURT SUMMONS IS \$100.00 EACH DAY IS A SEPARATE OFFENSE. THE CLEANUP BEING PERFORMED BY CITY OFFICIALS ON THE PROPERTY WILL RESULT IN PAYMENT AT THE OWNER(S) EXPENSE OF \$100.00 OR TEN PERCENT (10%) OF THE TOTAL COSTS INCURRED BY THE CITY TO REMEDY THE VIOLATION, WHICHEVER IS GREATER, AND AN ADDITION OF THE ACTUAL COST OF THE WORK INVOLVED IN CORRECTING THE CONDITIONS. A LIEN MAY BE FILED AGAINST THE PROPERTY AND AGAINST YOU AS THE OWNER FOR UNPAID FEES.

Thank You,

Office of Code Enforcement



~~6000~~ N Pearl St  
6000  
Inactive



## Notice of Violation

### City of Osceola

Office of Code Enforcement

303 West Hale Avenue P.O. Box 443

Osceola, AR 72370

Phone (870) 563-5245

Fax (870) 563-5195 or (870) 497-2228



02/14/2022

MOORE, JERRY R & NORMA M  
6004 N PEARL OSCEOLA AR 72370

Subject Property: 6004 N PEARL AR, , AR

Dear Property Owner:

YOU ARE HEREBY NOTIFIED TO DO THE FOLLOWING TO CORRECT THE VIOLATION(S) INDICATED BELOW:

**5.12.03 Weeds and Grass, Etc., Removal** - Weeds and grass, removal of rubbish, open storage, stagnant water. It shall be unlawful for any person owning and/or occupying any lot or real property within the City of Osceola, Arkansas, to allow weeds to grow thereon to a greater height of more than twelve (12) inches or to become unsightly or unsanitary, or to allow grass, garbage, rubbish, rotting or dead limbs or trees to become unsafe, unsightly and unsanitary or allow any icebox, refrigerator, stove, tires, building material, paper, building rubbish to be openly stored, or allow similar unsafe, unsightly and unsanitary. Ord. No. 2009-867.

**Property Maintenance** - 5.4.1 It shall be unlawful for the owner, owners or occupant of any lot or other real property within the City of Osceola, Arkansas to maintain or allow any dilapidated or unsightly building or structure on such lot or real property. Ord. No. 1991-650.

**Action to be taken:**

Violations must be corrected within 30 days.

FAILURE TO CORRECT VIOLATION(S) WILL RESULT IN ISSUANCE OF A COURT SUMMONS TO APPEAR IN DISTRICT COURT. THE MAXIMUM FINE PER COURT SUMMONS IS \$100.00 EACH DAY IS A SEPARATE OFFENSE. THE CLEANUP BEING PERFORMED BY CITY OFFICIALS ON THE PROPERTY WILL RESULT IN PAYMENT AT THE OWNER(S) EXPENSE OF \$100.00 OR TEN PERCENT (10%) OF THE TOTAL COSTS INCURRED BY THE CITY TO REMEDY THE VIOLATION, WHICHEVER IS GREATER, AND AN ADDITION OF THE ACTUAL COST OF THE WORK INVOLVED IN CORRECTING THE CONDITIONS. A LIEN MAY BE FILED AGAINST THE PROPERTY AND AGAINST YOU AS THE OWNER FOR UNPAID FEES.

Thank You,

Office of Code Enforcement





6004 N Pearl St  
Inactive



# BRYAN CATRINA

6004 N PEARL  
OSCEOLA, AR 72370-1670



## Basic Information

Parcel Number:	301-00399-000
County Name:	Mississippi County
Property Address:	BRYAN CATRINA 6004 N PEARL OSCEOLA, AR 72370-1670 <a href="#">Map This Address</a>

Mailing Address:

Collector's Mailing Address ⓘ:	BRYAN CATRINA L 2294 S COUNTY ROAD 91 OSCEOLA, AR 72370
--------------------------------	---

Total Acres:	0.20
Timber Acres:	0.00
Sec-Twp-Rng:	30-13-11
Lot/Block:	32/
Subdivision:	
Legal Description:	S53.3' N1243.5' E157.3' W197.3 FRL NW1/4 OF 30-13-11 30-13-11
School District:	1N OSCEOLA
Homestead Parcel?:	Yes
Tax Status:	Taxable
Over 65?:	No

Parcel Boundary



N Hodge Dr

St



Leaflet | © 2022 Microsoft, © 2022 TomTom

## Valuation Information

[view prior year information](#)

Entry	Appraised	Assessed
Land: ⓘ	6,500	1,300
Improvements: ⓘ	8,025	1,605
Total Value: ⓘ	14,525	2,905
Taxable Value: ⓘ		2,905
Millage:		0.0564
Estimated Taxes: ⓘ		\$163.84
Homestead Credit:		(\$163.84)
Estimated Taxes w Credit:		\$0.00
Assessment Year:		2021

## Tax Information

Year	Book	Tax Owed	Tax Paid	Balance
<u>2020</u>	Current	\$27.48	-\$27.48	\$0.00
<u>2019</u>	Delinquent	\$27.48	-\$27.48	\$0.00
<u>2018</u>	Delinquent	\$27.48	-\$27.48	\$0.00
<u>2017</u>	Delinquent	\$25.84	-\$25.84	\$0.00
<u>2016</u>	Delinquent	\$26.67	-\$26.67	\$0.00

## Receipts

Receipt #	Book	Tax Year	ReceiptDate	Cash Amt	Check Amt	Credit Amt	Total
<u>9461</u>	Current	2020	9/16/2021	\$0.00	\$0.00	\$169.54	<b>\$169.54</b>
<u>7001368</u>	Delinquent	2019	9/16/2021	\$0.00	\$0.00	\$154.10	<b>\$154.10</b>
<u>7001368</u>	Delinquent	2018	9/16/2021	\$0.00	\$0.00	\$154.10	<b>\$154.10</b>
<u>7001368</u>	Delinquent	2017	9/16/2021	\$0.00	\$0.00	\$154.10	<b>\$154.10</b>
<u>7001368</u>	Delinquent	2016	9/16/2021	\$0.00	\$0.00	\$154.10	<b>\$154.10</b>



## Sales History ⓘ

Filed	Sold	Price	Grantor	Grantee	Book	Page	Deed Type
9/15/2021	9/15/2021	0	MILLIKAN TREA D	BRYAN CATRINA	2021	006325	QCD(QUIT CLAIM DEED)
4/5/2017	2/7/2017	0	MOORE, JERRY R	MILLIKAN, TREA D	2017	1965	QCD(QUIT CLAIM DEED)
8/1/1990	8/1/1990	24,000	HUFFMAN, STANLEY & BOBBIE	MOORE, JERRY R	225	210	WD(WARRANTY DEED)
7/8/1986	7/8/1986	0	FEDERAL NATIONAL MTG	HUFFMAN, STANLEY & BOBBIE	207	363	
11/11/1985	11/11/1985	0	HILL, CHARLES & BRENDA	FEDERAL NATIONAL MTG	205	412	
2/8/1982	2/8/1982	0	DIXON, CHESTER	HILL, CHARLES & BRENDA	194	548	
1/1/1951	1/1/1951	0		DIXON, CHESTER			

## Improvement Information

## Residential Improvements

## Residential Improvement #1

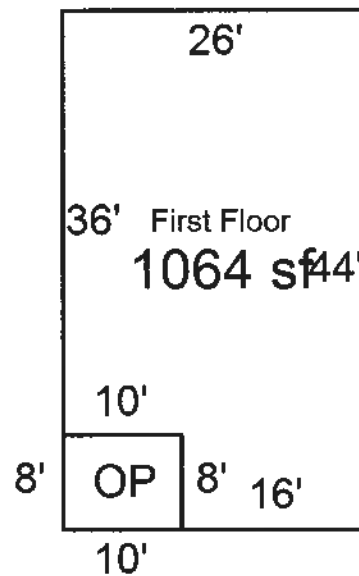

Living Area 1st Floor	1,064	Basement Unfinished	0
Living Area 2nd Floor	0	Basement Finished w/Partitions	0
		Basement Finished w/o Partitions	0
<b>Living Area Total SF</b>	<b>1,064</b>	<b>Basement Total SF</b>	<b>0</b>

Occupancy Type:	Single Family
Grade:	D5+5
Story Height:	1 Story
Year Built:	1985
Effective Age:	27
Construction Type:	Std Frame
Roof Type:	Asphalt

Heat / AC:	Floor/Wall Furnace
Fireplace:	0 0
Bathrooms:	1 full 0 half
Foundation Type:	Open Piers
Floor Type:	Wood Subfloor
Floor Covering:	carpet: 1,064 sq ft

Additive Items:	Additive Item	Quantity	Size	Description
	CPSM	35	5 x 7	STORAGE - MASONRY
	CP	266		CARPORTS
	OP	64	4 x 16	OPEN PORCH
	PS	270	15 x 18	PATIO SLAB

Outbuildings / Yard Improvements:	OBYI Item	Quantity	Size	Description
	CDW	580	10 x 58	CONCRETE DRIVEWAY
	CDW	456	12 x 38	CONCRETE DRIVEWAY
	CDW	64	8 x 8	CONCRETE DRIVEWAY
	FOB	1		
	WFX6	24	24 x 1	6' WOOD PRIVACY



## Notice of Violation

### City of Osceola

Office of Code Enforcement

303 West Hale Avenue P.O. Box 443

Osceola, AR 72370

Phone (870) 563-5245

Fax (870) 563-5195 or (870) 497-2228



02/14/2022

HARSHMAN RENTALS LLC  
202 W JOHNSON OSCEOLA AR 72370

*Tammy Burk*

Subject Property: 2004 WILLOW AR, , AR

Dear Property Owner:

YOU ARE HEREBY NOTIFIED TO DO THE FOLLOWING TO CORRECT THE VIOLATION(S) INDICATED BELOW:

**5.12.03 Weeds and Grass, Etc., Removal** - Weeds and grass, removal of rubbish, open storage, stagnant water. It shall be unlawful for any person owning and/or occupying any lot or real property within the City of Osceola, Arkansas, to allow weeds to grow thereon to a greater height of more than twelve (12) inches or to become unsightly or unsanitary, or to allow grass, garbage, rubbish, rotting or dead limbs or trees to become unsafe, unsightly and unsanitary or allow any icebox, refrigerator, stove, tires, building material, paper, building rubbish to be openly stored, or allow similar unsafe, unsightly and unsanitary. Ord. No. 2009-867.

**Action to be taken:**

Rubbish in carport must be addressed within 7 days.

FAILURE TO CORRECT VIOLATION(S) WILL RESULT IN ISSUANCE OF A COURT SUMMONS TO APPEAR IN DISTRICT COURT. THE MAXIMUM FINE PER COURT SUMMONS IS \$100.00 EACH DAY IS A SEPARATE OFFENSE. THE CLEANUP BEING PERFORMED BY CITY OFFICIALS ON THE PROPERTY WILL RESULT IN PAYMENT AT THE OWNER(S) EXPENSE OF \$100.00 OR TEN PERCENT (10%) OF THE TOTAL COSTS INCURRED BY THE CITY TO REMEDY THE VIOLATION, WHICHEVER IS GREATER, AND AN ADDITION OF THE ACTUAL COST OF THE WORK INVOLVED IN CORRECTING THE CONDITIONS. A LIEN MAY BE FILED AGAINST THE PROPERTY AND AGAINST YOU AS THE OWNER FOR UNPAID FEES.

Thank You,

Office of Code Enforcement



2004 Willow St  
Tammy Burk



## Notice of Violation

### City of Osceola

Office of Code Enforcement

303 West Hale Avenue P.O. Box 443

Osceola, AR 72370

Phone (870) 563-5245

Fax (870) 563-5195 or (870) 497-2228



02/14/2022

BARNHILL, VEATRIS MAE & ELVIS RICHMOND  
400 LAKEVIEW OSCEOLA AR 72370

Subject Property: 400 LAKEVIEW AR, , AR

Dear Property Owner:

YOU ARE HEREBY NOTIFIED TO DO THE FOLLOWING TO CORRECT THE VIOLATION(S) INDICATED BELOW:

**5.08.01 Inoperable Vehicles** - It shall be unlawful for the owner, owners, or occupant of any lot or other real property within the City of Osceola, Arkansas to utilize the premises for Commercial and/or open storage of any inoperable motor vehicle. An inoperable motor vehicle for the purpose of this Ordinance, is defined as one that is in a state of disrepair and incapable of being moved under it's own power or one that does not have current, valid license plates. Ord. No. 1993-679.

**5.12.03 Weeds and Grass, Etc., Removal** - Weeds and grass, removal of rubbish, open storage, stagnant water. It shall be unlawful for any person owning and/or occupying any lot or real property within the City of Osceola, Arkansas, to allow weeds to grow thereon to a greater height of more than twelve (12) inches or to become unsightly or unsanitary, or to allow grass, garbage, rubbish, rotting or dead limbs or trees to become unsafe, unsightly and unsanitary or allow any icebox, refrigerator, stove, tires, building material, paper, building rubbish to be openly stored, or allow similar unsafe, unsightly and unsanitary. Ord. No. 2009-867.

**Action to be taken:**

Violations must be corrected within 7 days.

FAILURE TO CORRECT VIOLATION(S) WILL RESULT IN ISSUANCE OF A COURT SUMMONS TO APPEAR IN DISTRICT COURT. THE MAXIMUM FINE PER COURT SUMMONS IS \$100.00 EACH DAY IS A SEPARATE OFFENSE. THE CLEANUP BEING PERFORMED BY CITY OFFICIALS ON THE PROPERTY WILL RESULT IN PAYMENT AT THE OWNER(S) EXPENSE OF \$100.00 OR TEN PERCENT (10%) OF THE TOTAL COSTS INCURRED BY THE CITY TO REMEDY THE VIOLATION, WHICHEVER IS GREATER, AND AN ADDITION OF THE ACTUAL COST OF THE WORK INVOLVED IN CORRECTING THE CONDITIONS. A LIEN MAY BE FILED AGAINST THE PROPERTY AND AGAINST YOU AS THE OWNER FOR UNPAID FEES.

Thank You,

Office of Code Enforcement



400 Lakeview Dr  
Inactive



## Notice of Violation

### City of Osceola

Office of Code Enforcement

303 West Hale Avenue P.O. Box 443

Osceola, AR 72370

Phone (870) 563-5245

Fax (870) 563-5195 or (870) 497-2228



02/14/2022

HARSHMAN RENTALS LLC  
202 W JOHNSON OSCEOLA AR 72370

*Lee Baker*

Subject Property: 122 GREEN ACRES AR, , AR

Dear Property Owner:

YOU ARE HEREBY NOTIFIED TO DO THE FOLLOWING TO CORRECT THE VIOLATION(S) INDICATED BELOW:

**5.12.03 Weeds and Grass, Etc., Removal** - Weeds and grass, removal of rubbish, open storage, stagnant water. It shall be unlawful for any person owning and/or occupying any lot or real property within the City of Osceola, Arkansas, to allow weeds to grow thereon to a greater height of more than twelve (12) inches or to become unsightly or unsanitary, or to allow grass, garbage, rubbish, rotting or dead limbs or trees to become unsafe, unsightly and unsanitary or allow any icebox, refrigerator, stove, tires, building material, paper, building rubbish to be openly stored, or allow similar unsafe, unsightly and unsanitary. Ord. No. 2009-867.

**Action to be taken:**

Rubbish in carport and front porch must be addressed within 7 days.

FAILURE TO CORRECT VIOLATION(S) WILL RESULT IN ISSUANCE OF A COURT SUMMONS TO APPEAR IN DISTRICT COURT. THE MAXIMUM FINE PER COURT SUMMONS IS \$100.00 EACH DAY IS A SEPARATE OFFENSE. THE CLEANUP BEING PERFORMED BY CITY OFFICIALS ON THE PROPERTY WILL RESULT IN PAYMENT AT THE OWNER(S) EXPENSE OF \$100.00 OR TEN PERCENT (10%) OF THE TOTAL COSTS INCURRED BY THE CITY TO REMEDY THE VIOLATION, WHICHEVER IS GREATER, AND AN ADDITION OF THE ACTUAL COST OF THE WORK INVOLVED IN CORRECTING THE CONDITIONS. A LIEN MAY BE FILED AGAINST THE PROPERTY AND AGAINST YOU AS THE OWNER FOR UNPAID FEES.

Thank You,

Office of Code Enforcement



122 W Green Acres Dr  
Rea Baker



## Notice of Violation

### City of Osceola

Office of Code Enforcement

303 West Hale Avenue P.O. Box 443

Osceola, AR 72370

Phone (870) 563-5245

Fax (870) 563-5195 or (870) 497-2228



02/14/2022

LONG, ESSIE MAE  
203 PARKWAY OSCEOLA AR 72370

Subject Property: 203 PARKWAY AR, , AR

Dear Property Owner:

YOU ARE HEREBY NOTIFIED TO DO THE FOLLOWING TO CORRECT THE VIOLATION(S) INDICATED BELOW:

**Property Maintenance - 5.4.1** It shall be unlawful for the owner, owners or occupant of any lot or other real property within the City of Osceola, Arkansas to maintain or allow any dilapidated or unsightly building or structure on such lot or real property. Ord. No. 1991-650.

**Action to be taken:**

Violations must be corrected within 30 days.

FAILURE TO CORRECT VIOLATION(S) WILL RESULT IN ISSUANCE OF A COURT SUMMONS TO APPEAR IN DISTRICT COURT. THE MAXIMUM FINE PER COURT SUMMONS IS \$100.00 EACH DAY IS A SEPARATE OFFENSE. THE CLEANUP BEING PERFORMED BY CITY OFFICIALS ON THE PROPERTY WILL RESULT IN PAYMENT AT THE OWNER(S) EXPENSE OF \$100.00 OR TEN PERCENT (10%) OF THE TOTAL COSTS INCURRED BY THE CITY TO REMEDY THE VIOLATION, WHICHEVER IS GREATER, AND AN ADDITION OF THE ACTUAL COST OF THE WORK INVOLVED IN CORRECTING THE CONDITIONS. A LIEN MAY BE FILED AGAINST THE PROPERTY AND AGAINST YOU AS THE OWNER FOR UNPAID FEES.

Thank You,

Office of Code Enforcement



203 Parkway St  
Inactive 2016



## Notice of Violation

### City of Osceola

Office of Code Enforcement

303 West Hale Avenue P.O. Box 443

Osceola, AR 72370

Phone (870) 563-5245

Fax (870) 563-5195 or (870) 497-2228



02/14/2022

WOODSON, BERNICE

610 SEMINOLE DR OSCEOLA AR 72370

Subject Property: 610 SEMINOLE AR, , AR

Dear Property Owner:

YOU ARE HEREBY NOTIFIED TO DO THE FOLLOWING TO CORRECT THE VIOLATION(S) INDICATED BELOW:

**5.08.01 Inoperable Vehicles** - It shall be unlawful for the owner, owners, or occupant of any lot or other real property within the City of Osceola, Arkansas to utilize the premises for Commercial and/or open storage of any inoperable motor vehicle. An inoperable motor vehicle for the purpose of this Ordinance, is defined as one that is in a state of disrepair and incapable of being moved under it's own power or one that does not have current, valid license plates. Ord. No. 1993-679.

**Action to be taken:**

violation must be corrected within 7 days.

FAILURE TO CORRECT VIOLATION(S) WILL RESULT IN ISSUANCE OF A COURT SUMMONS TO APPEAR IN DISTRICT COURT. THE MAXIMUM FINE PER COURT SUMMONS IS \$100.00 EACH DAY IS A SEPARATE OFFENSE. THE CLEANUP BEING PERFORMED BY CITY OFFICIALS ON THE PROPERTY WILL RESULT IN PAYMENT AT THE OWNER(S) EXPENSE OF \$100.00 OR TEN PERCENT (10%) OF THE TOTAL COSTS INCURRED BY THE CITY TO REMEDY THE VIOLATION, WHICHEVER IS GREATER, AND AN ADDITION OF THE ACTUAL COST OF THE WORK INVOLVED IN CORRECTING THE CONDITIONS. A LIEN MAY BE FILED AGAINST THE PROPERTY AND AGAINST YOU AS THE OWNER FOR UNPAID FEES.

Thank You,

Office of Code Enforcement



610 Seminole Dr  
Bernice Woodson



## Notice of Violation

### City of Osceola

Office of Code Enforcement

303 West Hale Avenue P.O. Box 443

Osceola, AR 72370

Phone (870) 563-5245

Fax (870) 563-5195 or (870) 497-2228



02/14/2022

*Valerie Jefferson*  
Subject Property: 105 PARKWAY AR, , AR

Dear Property Owner:

YOU ARE HEREBY NOTIFIED TO DO THE FOLLOWING TO CORRECT THE VIOLATION(S) INDICATED BELOW:

**5.08.01 Inoperable Vehicles** - It shall be unlawful for the owner, owners, or occupant of any lot or other real property within the City of Osceola, Arkansas to utilize the premises for Commercial and/or open storage of any inoperable motor vehicle. An inoperable motor vehicle for the purpose of this Ordinance, is defined as one that is in a state of disrepair and incapable of being moved under it's own power or one that does not have current, valid license plates. Ord. No. 1993-679.

**5.12.03 Weeds and Grass, Etc., Removal** - Weeds and grass, removal of rubbish, open storage, stagnant water. It shall be unlawful for any person owning and/or occupying any lot or real property within the City of Osceola, Arkansas, to allow weeds to grow thereon to a greater height of more than twelve (12) inches or to become unsightly or unsanitary, or to allow grass, garbage, rubbish, rotting or dead limbs or trees to become unsafe, unsightly and unsanitary or allow any icebox, refrigerator, stove, tires, building material, paper, building rubbish to be openly stored, or allow similar unsafe, unsightly and unsanitary. Ord. No. 2009-867.

**Action to be taken:**

Rubbish on exterior property must be removed. Violations must be corrected within 30 days.

FAILURE TO CORRECT VIOLATION(S) WILL RESULT IN ISSUANCE OF A COURT SUMMONS TO APPEAR IN DISTRICT COURT. THE MAXIMUM FINE PER COURT SUMMONS IS \$100.00 EACH DAY IS A SEPARATE OFFENSE. THE CLEANUP BEING PERFORMED BY CITY OFFICIALS ON THE PROPERTY WILL RESULT IN PAYMENT AT THE OWNER(S) EXPENSE OF \$100.00 OR TEN PERCENT (10%) OF THE TOTAL COSTS INCURRED BY THE CITY TO REMEDY THE VIOLATION, WHICHEVER IS GREATER, AND AN ADDITION OF THE ACTUAL COST OF THE WORK INVOLVED IN CORRECTING THE CONDITIONS. A LIEN MAY BE FILED AGAINST THE PROPERTY AND AGAINST YOU AS THE OWNER FOR UNPAID FEES.

Thank You,

Office of Code Enforcement



105 Parkway St  
Valerie Jefferson



## Notice of Violation

### City of Osceola

Office of Code Enforcement

303 West Hale Avenue P.O. Box 443

Osceola, AR 72370

Phone (870) 563-5245

Fax (870) 563-5195 or (870) 497-2228



02/14/2022

LOVE, J D  
16 N CEDAR LANE GLENWOOD IL 60425

Subject Property: 511 N ELM AR, , AR

Dear Property Owner:

YOU ARE HEREBY NOTIFIED TO DO THE FOLLOWING TO CORRECT THE VIOLATION(S) INDICATED BELOW:

**5.04.01 Property Maintenance** - It shall be unlawful for the owner, owners or occupant of any lot or other real property within the City of Osceola, Arkansas to maintain or allow any dilapidated or unsightly building or structure on such lot or real property. Ord. No. 1991-650.

**Action to be taken:**

Violation must be corrected within 30 days.

FAILURE TO CORRECT VIOLATION(S) WILL RESULT IN ISSUANCE OF A COURT SUMMONS TO APPEAR IN DISTRICT COURT. THE MAXIMUM FINE PER COURT SUMMONS IS \$100.00 EACH DAY IS A SEPARATE OFFENSE. THE CLEANUP BEING PERFORMED BY CITY OFFICIALS ON THE PROPERTY WILL RESULT IN PAYMENT AT THE OWNER(S) EXPENSE OF \$100.00 OR TEN PERCENT (10%) OF THE TOTAL COSTS INCURRED BY THE CITY TO REMEDY THE VIOLATION, WHICHEVER IS GREATER, AND AN ADDITION OF THE ACTUAL COST OF THE WORK INVOLVED IN CORRECTING THE CONDITIONS. A LIEN MAY BE FILED AGAINST THE PROPERTY AND AGAINST YOU AS THE OWNER FOR UNPAID FEES.

Thank You,

Office of Code Enforcement



Sll N Elm St  
Inactive



## Notice of Violation

### City of Osceola

Office of Code Enforcement

303 West Hale Avenue P.O. Box 443

Osceola, AR 72370

Phone (870) 563-5245

Fax (870) 563-5195 or (870) 497-2228



02/14/2022

HARSHMAN RENTALS LLC  
202 W JOHNSON OSCEOLA AR 72370

*Christopher Johnson*

Subject Property: 907 S GARDEN AR, , AR

Dear Property Owner:

YOU ARE HEREBY NOTIFIED TO DO THE FOLLOWING TO CORRECT THE VIOLATION(S) INDICATED BELOW:

**5.12.03 Weeds and Grass, Etc., Removal** - Weeds and grass, removal of rubbish, open storage, stagnant water. It shall be unlawful for any person owning and/or occupying any lot or real property within the City of Osceola, Arkansas, to allow weeds to grow thereon to a greater height of more than twelve (12) inches or to become unsightly or unsanitary, or to allow grass, garbage, rubbish, rotting or dead limbs or trees to become unsafe, unsightly and unsanitary or allow any icebox, refrigerator, stove, tires, building material, paper, building rubbish to be openly stored, or allow similar unsafe, unsightly and unsanitary. Ord. No. 2009-867.

**Action to be taken:**

Violations must be corrected within 7 days. Front door leaning against house and rubbish in carport must be addressed.

FAILURE TO CORRECT VIOLATION(S) WILL RESULT IN ISSUANCE OF A COURT SUMMONS TO APPEAR IN DISTRICT COURT. THE MAXIMUM FINE PER COURT SUMMONS IS \$100.00 EACH DAY IS A SEPARATE OFFENSE. THE CLEANUP BEING PERFORMED BY CITY OFFICIALS ON THE PROPERTY WILL RESULT IN PAYMENT AT THE OWNER(S) EXPENSE OF \$100.00 OR TEN PERCENT (10%) OF THE TOTAL COSTS INCURRED BY THE CITY TO REMEDY THE VIOLATION, WHICHEVER IS GREATER, AND AN ADDITION OF THE ACTUAL COST OF THE WORK INVOLVED IN CORRECTING THE CONDITIONS. A LIEN MAY BE FILED AGAINST THE PROPERTY AND AGAINST YOU AS THE OWNER FOR UNPAID FEES.

Thank You,

Office of Code Enforcement



907 S Garden  
Christopher  
Johnson



## Notice of Violation

### City of Osceola

Office of Code Enforcement

303 West Hale Avenue P.O. Box 443

Osceola, AR 72370

Phone (870) 563-5245

Fax (870) 563-5195 or (870) 497-2228



02/14/2022

HARRIS, GITA  
223 E SEMMES OSCEOLA AR 72370

Subject Property: 301 ADAMS AR, , AR

Dear Property Owner:

YOU ARE HEREBY NOTIFIED TO DO THE FOLLOWING TO CORRECT THE VIOLATION(S) INDICATED BELOW:

**5.08.01 Inoperable Vehicles** - It shall be unlawful for the owner, owners, or occupant of any lot or other real property within the City of Osceola, Arkansas to utilize the premises for Commercial and/or open storage of any inoperable motor vehicle. An inoperable motor vehicle for the purpose of this Ordinance, is defined as one that is in a state of disrepair and incapable of being moved under it's own power or one that does not have current, valid license plates. Ord. No. 1993-679.

**Action to be taken:**

Inoperable vehicle must be addressed within 7 days.

FAILURE TO CORRECT VIOLATION(S) WILL RESULT IN ISSUANCE OF A COURT SUMMONS TO APPEAR IN DISTRICT COURT. THE MAXIMUM FINE PER COURT SUMMONS IS \$100.00 EACH DAY IS A SEPARATE OFFENSE. THE CLEANUP BEING PERFORMED BY CITY OFFICIALS ON THE PROPERTY WILL RESULT IN PAYMENT AT THE OWNER(S) EXPENSE OF \$100.00 OR TEN PERCENT (10%) OF THE TOTAL COSTS INCURRED BY THE CITY TO REMEDY THE VIOLATION, WHICHEVER IS GREATER, AND AN ADDITION OF THE ACTUAL COST OF THE WORK INVOLVED IN CORRECTING THE CONDITIONS. A LIEN MAY BE FILED AGAINST THE PROPERTY AND AGAINST YOU AS THE OWNER FOR UNPAID FEES.

Thank You,

Office of Code Enforcement



301 Adams St  
Candaisy Harris



## Notice of Violation

### City of Osceola

Office of Code Enforcement

303 West Hale Avenue P.O. Box 443

Osceola, AR 72370

Phone (870) 563-5245

Fax (870) 563-5195 or (870) 497-2228



02/14/2022

PRINCE, DELORIS

425 W JOHNSON OSCEOLA AR 72370

Subject Property: 425 W JOHNSON OSCEOLA AR, , AR

Dear Property Owner:

YOU ARE HEREBY NOTIFIED TO DO THE FOLLOWING TO CORRECT THE VIOLATION(S) INDICATED BELOW:

**5.04.01 Property Maintenance** - It shall be unlawful for the owner, owners or occupant of any lot or other real property within the City of Osceola, Arkansas to maintain or allow any dilapidated or unsightly building or structure on such lot or real property. Ord. No. 1991-650.

**Action to be taken:**

Violation must be corrected within 30 days.

FAILURE TO CORRECT VIOLATION(S) WILL RESULT IN ISSUANCE OF A COURT SUMMONS TO APPEAR IN DISTRICT COURT. THE MAXIMUM FINE PER COURT SUMMONS IS \$100.00 EACH DAY IS A SEPARATE OFFENSE. THE CLEANUP BEING PERFORMED BY CITY OFFICIALS ON THE PROPERTY WILL RESULT IN PAYMENT AT THE OWNER(S) EXPENSE OF \$100.00 OR TEN PERCENT (10%) OF THE TOTAL COSTS INCURRED BY THE CITY TO REMEDY THE VIOLATION, WHICHEVER IS GREATER, AND AN ADDITION OF THE ACTUAL COST OF THE WORK INVOLVED IN CORRECTING THE CONDITIONS. A LIEN MAY BE FILED AGAINST THE PROPERTY AND AGAINST YOU AS THE OWNER FOR UNPAID FEES.

Thank You,

Office of Code Enforcement



425 W Johnson Ave  
not in system  
Inactive